

MUR25xx/MURxxR

Ultra-Fast Recovery Rectifier
 Reverse Voltage 50-600V Forward Current 25A

Features

- High Surge Capability
- Reverse Voltage 50V-600V
- Standard Polarity: Stud=Cathod
- Reverse Polarity (R): Stud= Anode



DO-4



MUR25xx



MUR25xxR

Absolute Maximum Ratings (T_A=25°C unless otherwise specified)

Parameter	Symbol	MUR2505	MUR2510	MUR2520	MUR2540	MUR2560	Unit	
Peak Repetitive Reverse Voltage	V _{RRM}	50	100	200	400	600	V	
Maximum RMS Voltage	V _{RMS}	35	70	140	280	420	V	
DC Blocking Voltage	V _R	50	100	200	400	600	V	
Average Rectified Forward Current (Rated VR)	I _{F(AV)}	25.0 @ T _L = 120°C						A
Peak Forward Surge Current (8.3ms, Half Sine)	I _{FSM}	500						A
Operating and Storage Junction Temperature Range	T _J , T _{STG}	-50 to +150						°C

Note : For reverse polarity, add "R" after standard part number.

Electrical Characteristics (T_A=25°C unless otherwise specified)

Parameter	Test Conditions	Symbol	MUR2505	MUR2510	MUR2520	MUR2540	MUR2560	Unit
Maximum Instantaneous Forward Voltage	(I _F =25.0A, T _A =25°C)	V _F	0.95	0.95	0.95	1.25	1.25	V
Maximum DC Reverse Current	(Rated dc voltage, T _A = 25°C)	I _R	10	10	10	10	10	μA
Maximum Reverse Recovery Time	(I _F =0.5A, I _R =1.0A, I _{REC} = 0.25A)	T _{RR}	70	70	70	75	75	ns
Typical Junction Capacitance	@1.0MHz, V _R =4.0V	C _J	100	100	100	100	100	pF

Note : Pulse Test: Pulse Width 300μsec, Duty Cycle 1%

Typical Characteristic Curves

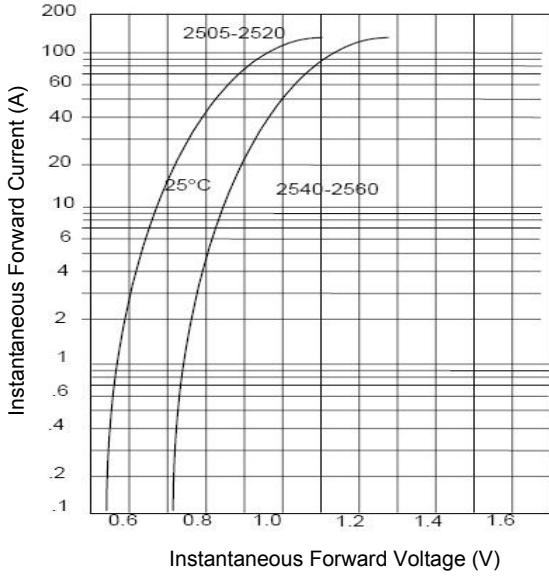

Fig 1. Typical Forward Characteristics

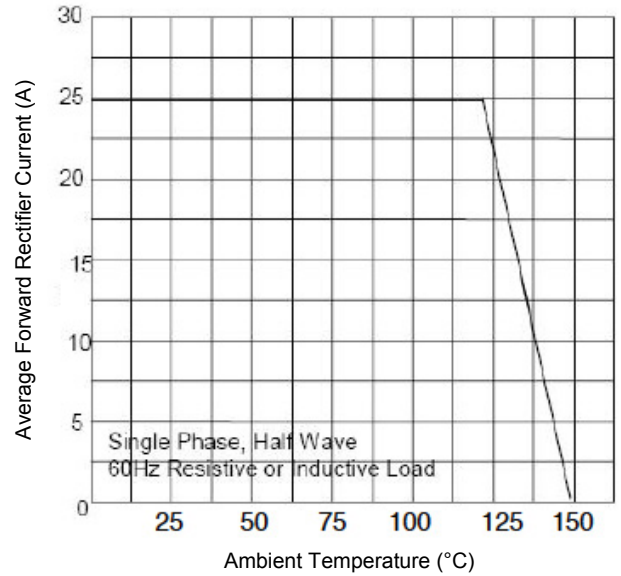

Fig 2. Forward Derating Curve

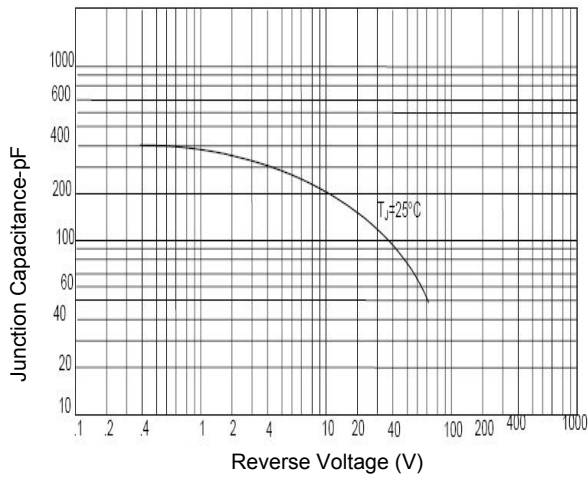

Fig 3. Junction Capacitance

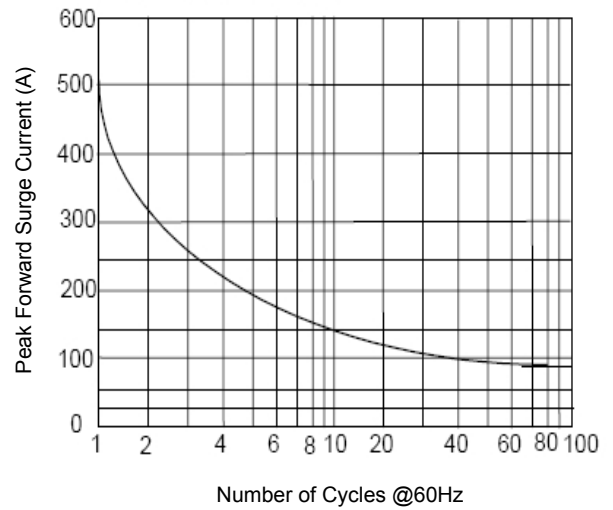

Fig 4. Peak Forward Surge Current

Typical Characteristic Curves

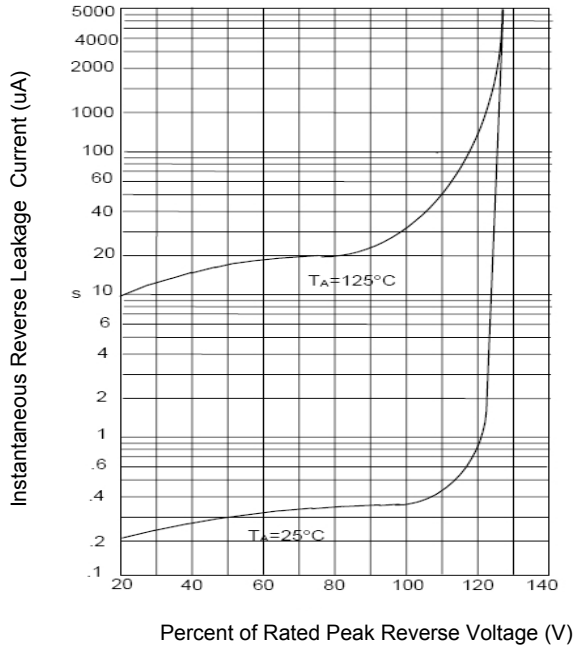
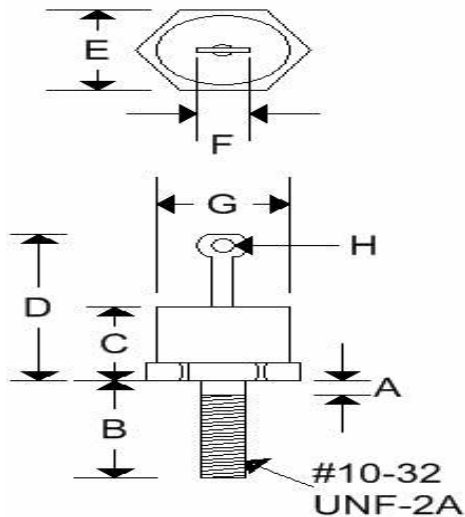

Fig 5. Typical Reverse Characteristics

Package Outline Dimensions



	DO-4(R)			
	Inches		Millimeters	
	Min	Max	Min	Max
A	-	0.078	-	1.981
B	0.422	0.453	10.719	11.506
C	-	0.405	-	10.287
D	-	0.800	-	20.320
E	0.420	0.440	10.668	11.176
F	-	0.250	-	6.350
G	-	0.424	-	10.770
H	0.066	-	1.676	-