

# GSTP0220S thru GSTP0240S

Surface Mount Schottky Rectifier  
 Reverse Voltage 20-40V Forward Current 2A

## Features

- Low profile - typical height of 0.65 mm
- Moisture sensitivity: level 1, per J-STD-020
- Low forward voltage drop
- High temperature soldering guaranteed: 260°C/10 seconds



Package: iSGP  
(SOD-323HS)



**RoHS**  
COMPLIANT

## Maximum Ratings (T<sub>A</sub> = 25°C unless otherwise noted)

Parameter	Symbol	GSTP0220S	GSTP0230S	GSTP0240S	Unit
Maximum Repetitive Peak Reverse Voltage	V <sub>RRM</sub>	20	30	40	V
Maximum RMS Voltage	V <sub>RMS</sub>	14	21	28	V
Maximum DC Blocking Voltage	V <sub>DC</sub>	20	30	40	V
Maximum Average Forward Rectified Current	I <sub>F(AV)</sub>	2.0			A
Peak Forward Surge Current (8.3 ms single half sine-wave superimposed on rated load)	I <sub>FSM</sub>	30			A
Operating Junction Temperature Range	T <sub>J</sub>	- 55 to + 150			°C
Storage Temperature Range	T <sub>STG</sub>	- 55 to + 150			°C

## Electrical Characteristics (T<sub>A</sub> = 25°C unless otherwise noted)

Parameter	Symbol	Test Conditions	Value	Unit
Maximum Instantaneous Forward Voltage	V <sub>F</sub>	I <sub>F</sub> =2A, T <sub>A</sub> =125°C	0.60	V
Maximum DC Reverse Current at Rated DC Blocking Voltage	I <sub>R</sub>	T <sub>A</sub> =25°C	250	μA

# GSTP0220S thru GSTP0240S

Surface Mount Schottky Rectifier  
 Reverse Voltage 20-40V Forward Current 2A

## Package Outline Dimensions

iSGP (SOD-323HS)

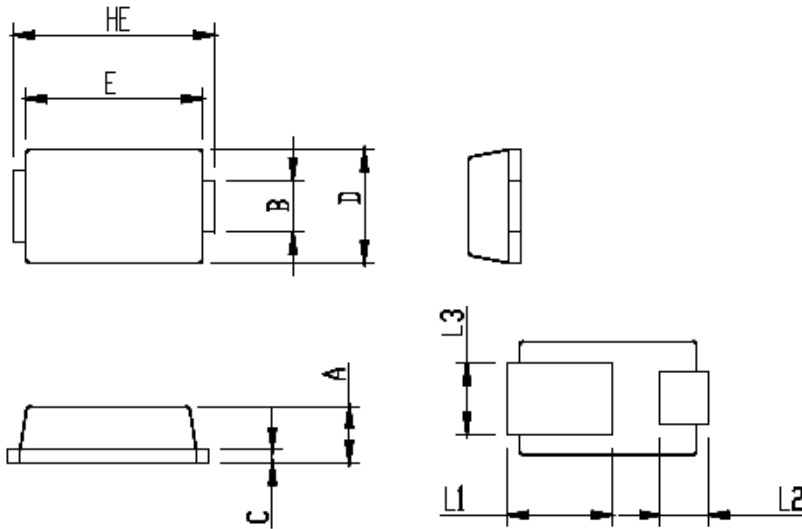

Package	Unit:mm	
	MIN	MAX
iSGP		
A	0.60	0.73
B	0.55	0.75
C	0.10	0.25
D	1.20	1.40
E	2.10	2.30
HE	2.30	2.70
L1	1.10	1.50
L2	0.40	0.75
L3	0.75	1.00

## Suggested Pad Layout

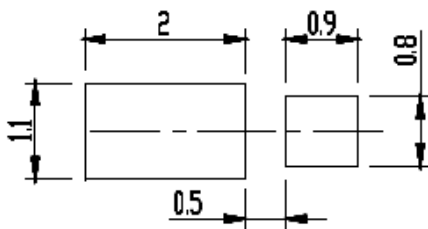

## Packing Information

### Packing Quantities:

15000 pcs/Reel, 18 Reels/Box, 8mm Tape, 13" Reel

## Tape & Reel Specification

