

GMBRD10150S-GMBRD10200S

Schottky Rectifiers
Reverse Voltage 150-200V Forward Current 10A

Features

- High surge capacity
- High current capacity
- Low forward voltage drop
- Guard ring for overvoltage protection

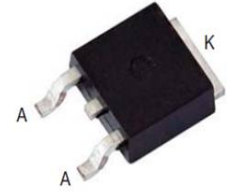

Package: TO-252 (D-PAK)



RoHS
COMPLIANT

Absolute Maximum Ratings

(T_A=25°C unless otherwise specified)

Parameter	Symbol	GMBRD10150S	GMBRD10200S	Unit
Current Peak Reverse Voltage	V _{RRM}	150	200	V
RMS Voltage	V _{RMS}	105	140	V
DC Blocking Voltage	V _D	150	200	V
Average Forward Rectified Current @T _A =100°C	I _{F(AV)}	10		A
Peak Forward Surge Current 8.3ms Single Half Sine-wave Superimosed on Rated Load	I _{FSM}	150		A
Thermal Resistance, Junction-to-Case	R _{θJC}	2.2		°C/W
Storage Temperature Range	T _{STG}	-55 To +150		°C
Operating Junction Temperature Range	T _J	-55 To +150		°C

Electrical Characteristics

(T_A=25°C unless otherwise specified)

Parameter	Symbol	Conditions	Max.		Unit.
			GMBRD10150S	GMBRD10200S	
Forward Voltage ¹	V _F	I _F =10A, T _A =25°C	0.9	0.95	V
Reverse Current	I _R	T _A =25°C, V _R =V _{RRM}	0.1		mA
		T _A =125°C, V _R =V _{RRM}	50		

Note1:Pulse test:300us pulse width, 1% duty cycle

Typical Electrical and Thermal Characteristic Curves

($T_A=25^{\circ}\text{C}$ unless otherwise specified)

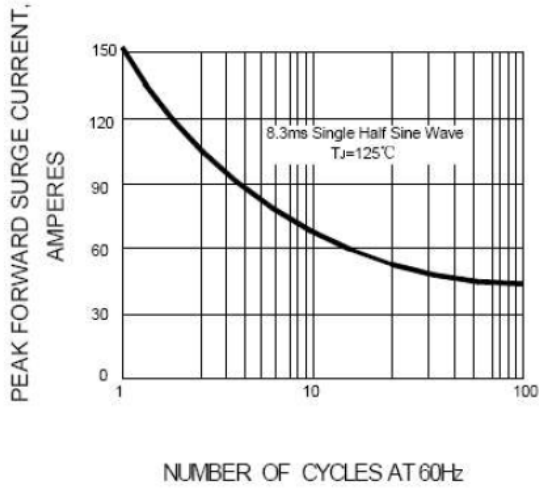

Figure 1. Peak Pulse Power Surge Current

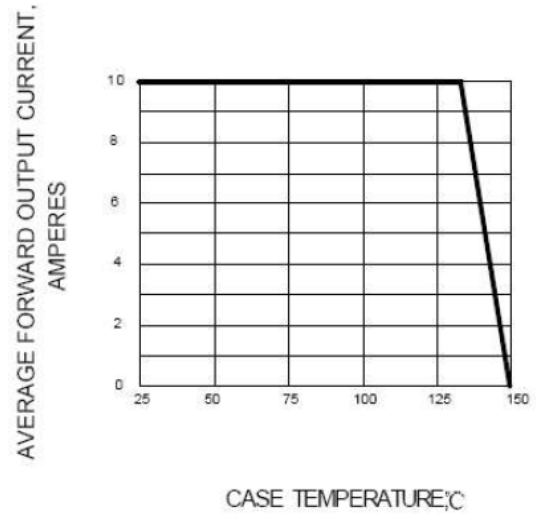
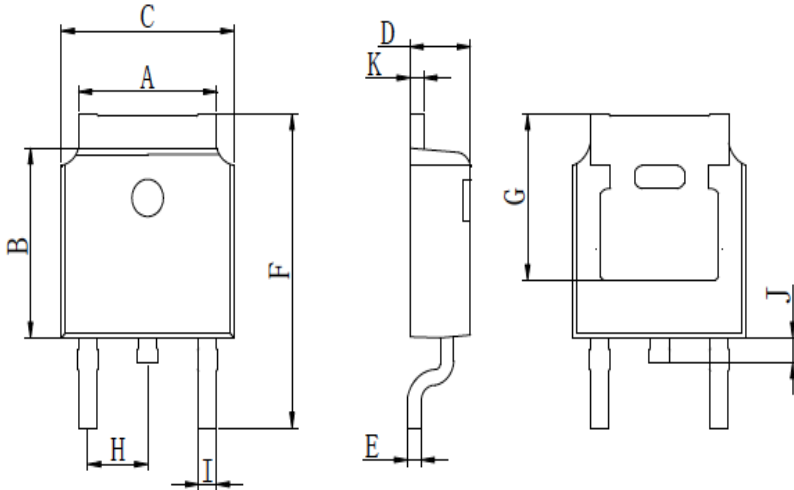

Figure 2. Forward Derating Curve

GMBRD10150S-GMBRD10200S

Schottky Rectifiers
 Reverse Voltage 150-200V Forward Current 10A

Package Outline Dimensions (TO-252/DPAK)



TO-252		
A	5.05	5.65
B	5.80	6.40
C	6.25	6.85
D	2.20	2.40
E	0.40	0.60
F	9.71	10.31
G	5.05	5.65
H	2.10	2.50
I	0.70	0.90
J	0.50	0.70
K	0.40	0.60
All Dimensions in mm		

Suggested Pad Layout

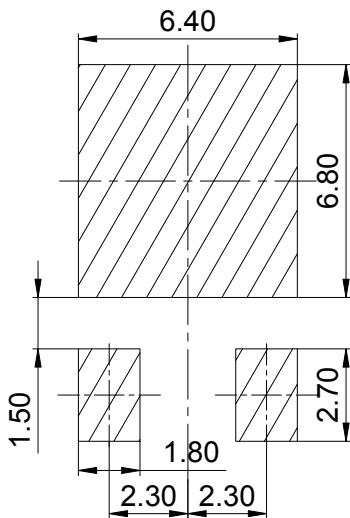

Unit:mm