

# GSGPD220S thru SGP2BS

Surface Mount Schottky Rectifier  
 Reverse Voltage 20-100V Forward Current 0.2A

## Features

- Low VF Schottky barrier diodes
- Low profile - typical height of 1.0 mm
- Low forward voltage drop
- Low leakage current
- Moisture sensitivity: level 1, per J-STD-020
- High temperature soldering guaranteed: 260°C/10 seconds
- Halogen-free according to IEC 61249-2-21 definition

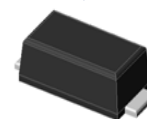

eSGP(SOD-323F)



**RoHS**  
COMPLIANT

## Maximum Ratings ( $T_A = 25^\circ\text{C}$ unless otherwise noted)

Parameter	Symbol	GSGPD220S	GSGPD240S	GSGPD260S	GSGPD2BS	Unit
Maximum repetitive peak reverse voltage	VRRM	20	40	60	100	V
Maximum RMS voltage	VRMS	14	28	42	70	V
Maximum DC blocking voltage	VDC	20	40	60	100	V
Maximum average forward rectified current	IF(AV)	0.2				A
Peak forward surge current 8.3 ms single half sine-wave superimposed on rated load	IFSM	10				A
Operating junction and storage temperature range	TJ, TSTG	- 55 to + 150				°C

## Electrical Characteristics ( $T_A = 25^\circ\text{C}$ unless otherwise noted)

Parameter	Test Conditions	Symbol	GSGPD220S	GSGPD240S	GSGPD260S	GSGPD2BS	Unit
Maximum instantaneous forward voltage	0.2A	$V_F$	0.45	0.50	0.60	0.80	V
Maximum DC reverse current at rated DC blocking voltage	$T_A=25^\circ\text{C}$	$I_R$	80.00		50.00		uA
	$T_A=125^\circ\text{C}$		30				mA
Typical junction capacitance	4.0 V, 1 MHz	$C_J$	18	13	12	9	pF
Typical thermal resistance	junction to mount	$R_{\theta JM}$	55				°C/W

Note:1),The thermal resistance from junction to mount,mounted on P.C.B with 5x5mm copper pads,2 OZ,FR4 PCB

## Ratings and Characteristics Curves ( $T_A = 25^\circ\text{C}$ unless otherwise noted)

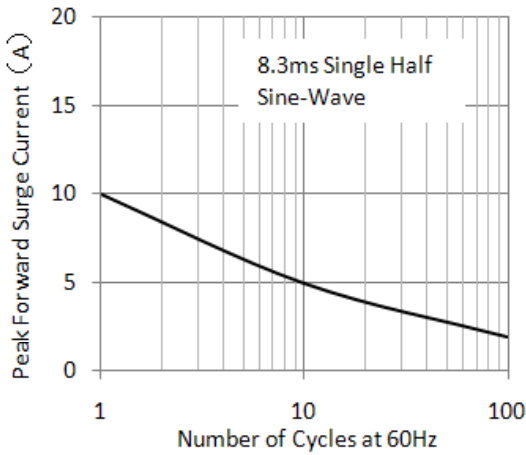

Figure 1. Maximum Non-Repetitive Peak Forward Surge Current

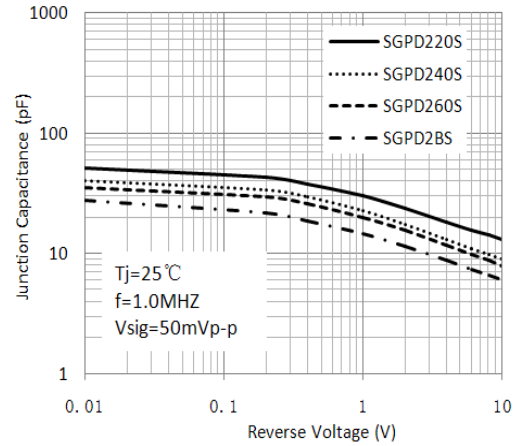

Figure 2. Typical Junction Capacitance

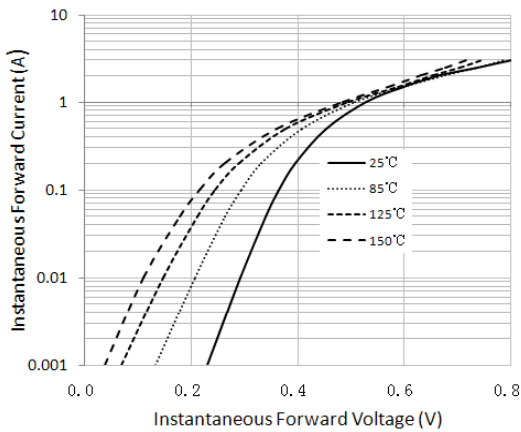

Figure 3. Typical Instantaneous Forward Characteristics (GSGPD220S)

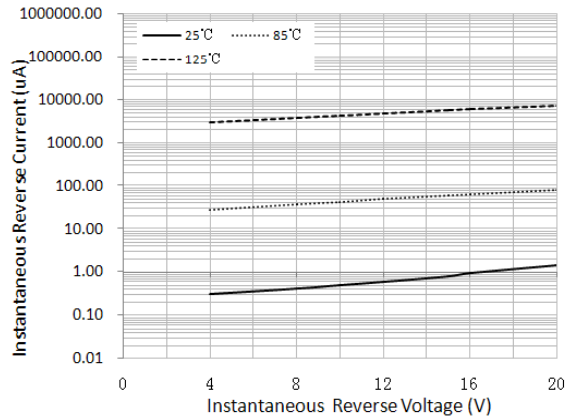

Figure 4. Typical Reverse Characteristics (GSGPD220S)

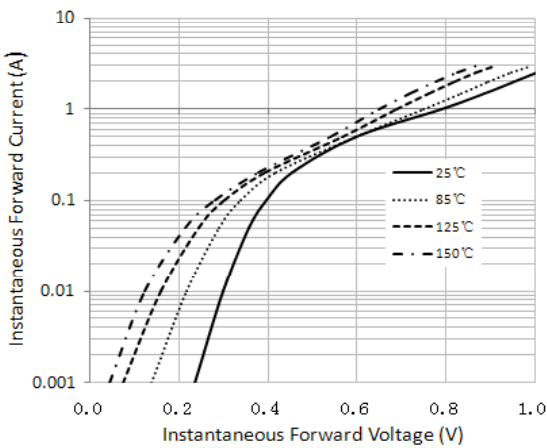

Figure 5. Typical Instantaneous Forward Characteristics (GSGPD240S)

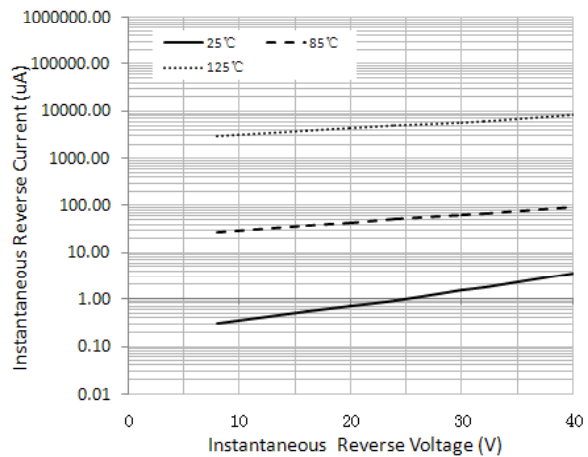

Figure 6. Typical Reverse Characteristics (GSGPD240S)

## **Ratings and Characteristics Curves**

( $T_A = 25^\circ\text{C}$  unless otherwise noted)

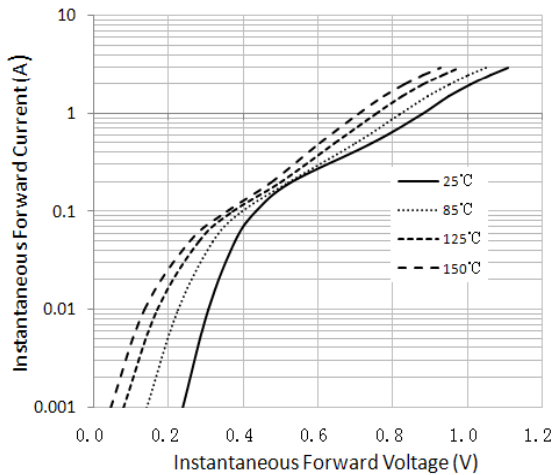

Figure 7. Typical Instantaneous Forward Characteristics (GSGPD260S)

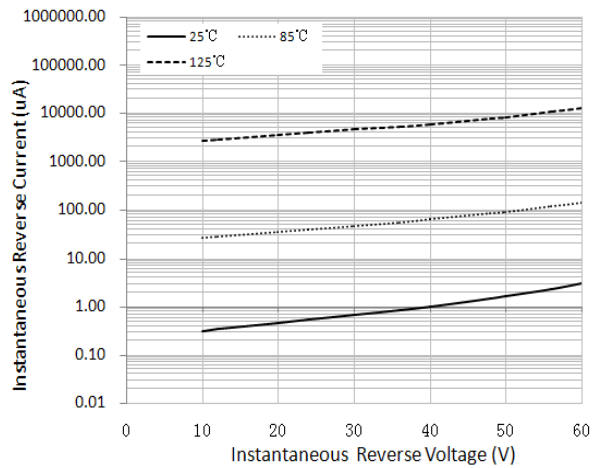

Figure 8. Typical Reverse Characteristics (GSGPD260S)

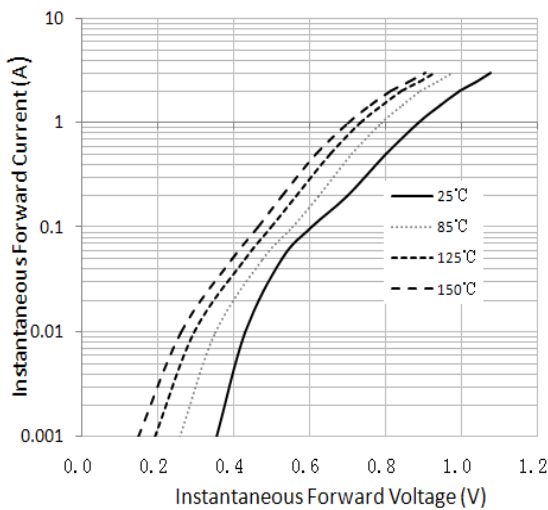

Figure 9. Typical Instantaneous Forward Characteristics (GSGPD2BS)

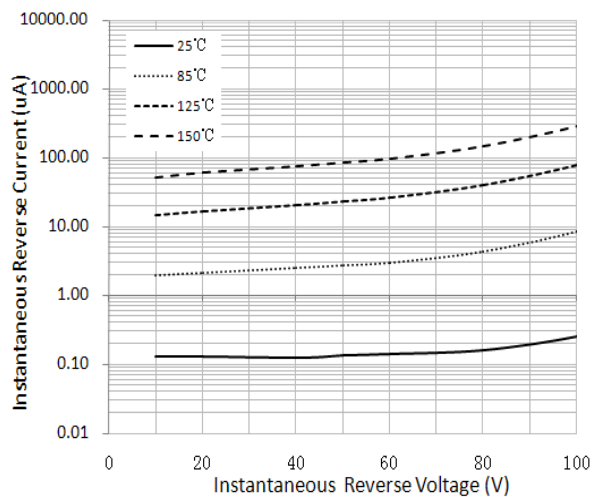

Figure 10. Typical Reverse Characteristics (GSGPD2BS)

# GSGPD220S thru GSGPD2BS

Surface Mount Schottky Rectifier  
 Reverse Voltage 20-100V Forward Current 0.2A

## Package Outline Dimensions

eSGP(SOD-323F)

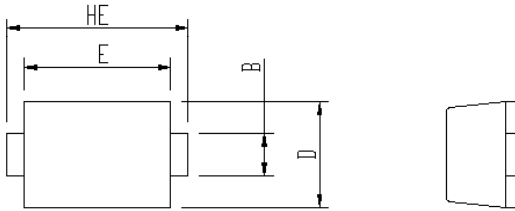

Package	Unit:mm		Unit:inch	
	MIN	MAX	MIN	MAX
eSGP				
A	0.9	1.08	0.035	0.043
B	0.5	0.7	0.020	0.028
C	0.1	0.25	0.004	0.010
D	1.4	1.6	0.055	0.063
E	2.0	2.2	0.079	0.087
L	0.35	0.65	0.014	0.026
HE	2.4	2.8	0.094	0.110

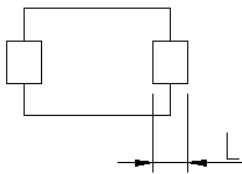
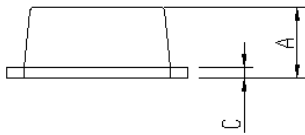

Soldering footprint

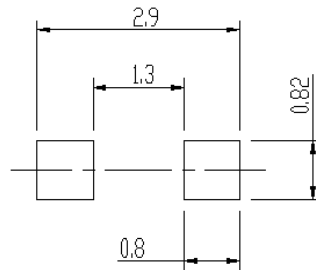

## Packing Information

### Packing Quantities:

3000 pcs/Reel, 40 Reels/Box; 8mm Tape, 7" Reel

### Tape & Reel Specification

