

MB22M thru MB210M

Schottky Bridge Rectifier
 Reverse Voltage 20 to 100V Forward Current 2A

Features

- Plastic package has Underwriters Laboratory Flammability Classification 94V-0
- High surge overload rating: 50A peak
- High temperature soldering guaranteed: 260°C/10 seconds

Mechanical Data

- **Case:** Molded plastic body over passivated junctions
- **Terminals:** Plated leads solderable per MIL-STD-750 Method 2026
- Mounting Position: Any
- Weight: 0.078oz., 0.22g
- Long pointed leads 3.70mm - 4.05 mm

Package: MBM

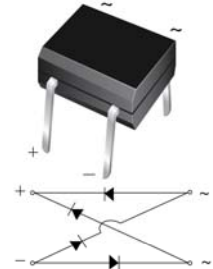

Schematic Diagram

Maximum Ratings & Electrical Characteristics

($T_A=25^\circ\text{C}$ unless otherwise noted)

Parameter	Symbol	MB22M	MB24M	MB26M	MB28M	MB210M	Unit
Maximum Repetitive Peak Reverse Voltage	V_{RRM}	20	40	60	80	100	V
Maximum RMS Voltage	V_{RMS}	14	28	42	56	70	V
Maximum DC Blocking Voltage	V_{DC}	20	40	60	80	100	V
Maximum Average Forward Output Current	$I_{F(AV)}$	2.0					A
Peak Forward Surge Current 8.3 MS Single Half Sine-Wave Superimposed on Rated Load (JEDEC Method)	I_{FSM}	50					A
Maximum Instantaneous Forward Voltage at 2.0A	V_F	0.55		0.70		0.85	V
Maximum DC Reverse Current at Rated $T_A=25^\circ\text{C}$	I_R	0.5					mA
DC Blocking Voltage per Leg $T_A=100^\circ\text{C}$		20					
Operation Junction Temperature Range	T_J	-55 to +125					$^\circ\text{C}$
Storage Temperature Range	T_{STG}	-55 to +150					$^\circ\text{C}$

Ratings and Characteristics Curves

($T_A = 25^\circ\text{C}$ unless otherwise noted)

FIG. 1 - FORWARD CURRENT DERATING CURVE

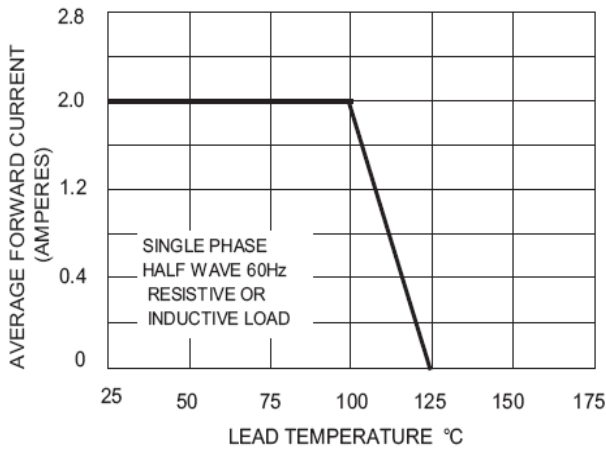

FIG. 2 - MAXIMUM NON-REPETITIVE SURGE CURRENT

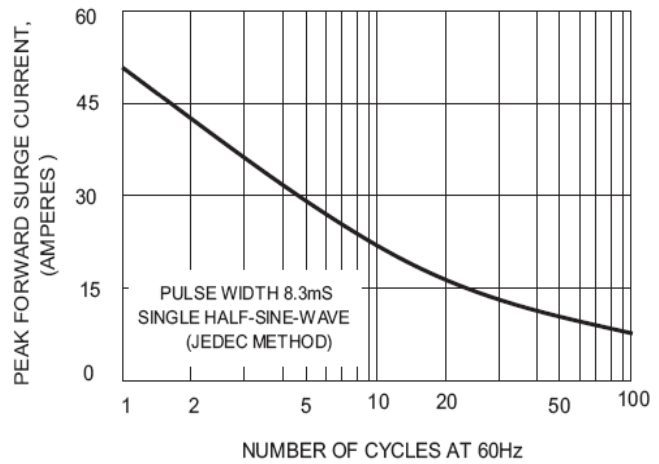

FIG.3-TYPICAL FORWARD CHARACTERISTICS

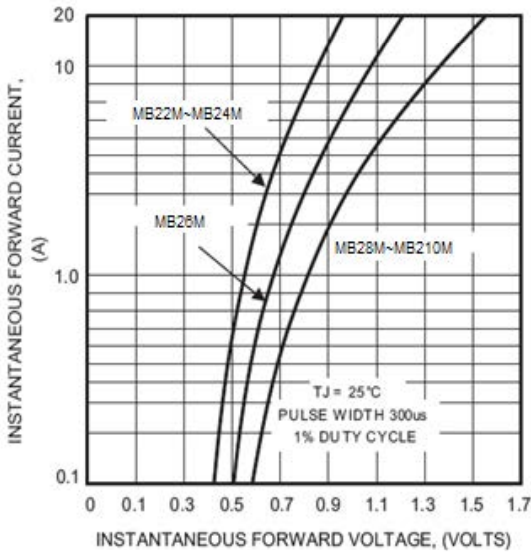
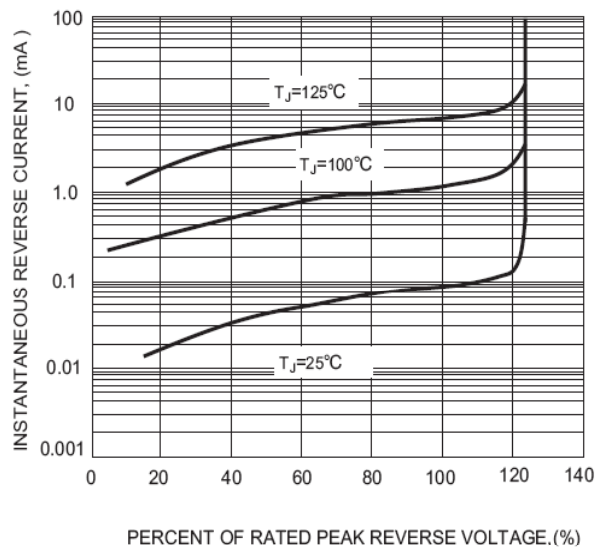

FIG.5-TYPICAL REVERSE CHARACTERISTICS



MB22M thru MB210M

Schottky Bridge Rectifier
 Reverse Voltage 20 to 100V Forward Current 2A

Package Outline Dimensions

MBM

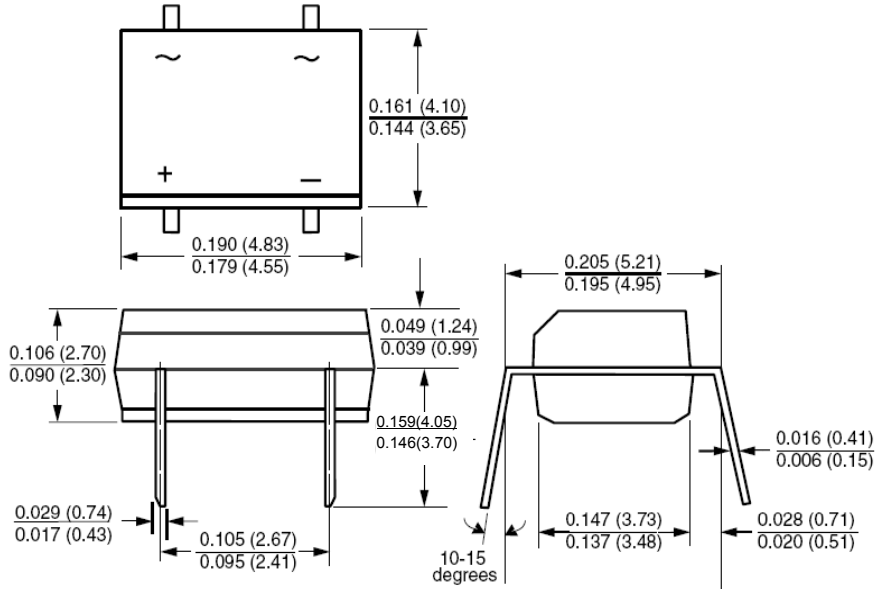

Dimensions in inches and (millimeters)

Marking

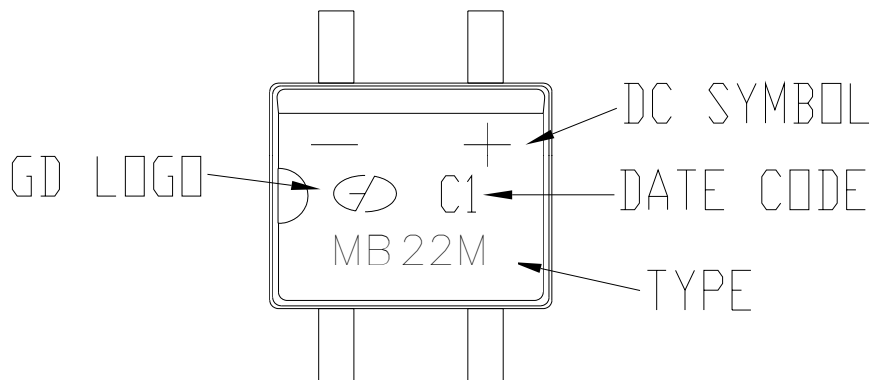

DATE CODE

Year	2009	2010	2011	2012	2013	2014	2015	2016	2017	2018	2019	2020
Code	9	A	B	C	D	E	F	G	H	J	K	0
Month	1	2	3	4	5	6	7	8	9	10	11	12
Code	1	2	3	4	5	6	7	8	9	O	N	D