

Main Product Characteristics

$V_{(BR)DSS}$	-60V
$R_{DS(ON)}$	180mΩ
I_D	-7A

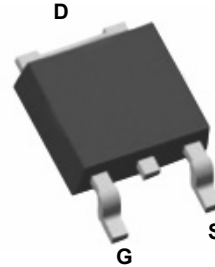

TO-252 (DPAK)

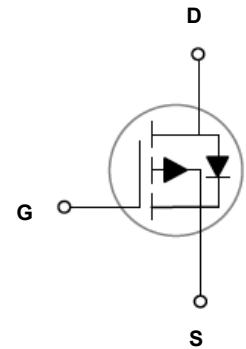

Schematic Diagram

Features and Benefits

- Advanced MOSFET process technology
- Ideal for high efficiency switched mode power supplies
- Low on-resistance with low gate charge
- Fast switching and reverse body recovery



Description

The SSFD6911 utilizes the latest techniques to achieve high cell density and low on-resistance. These features make this device extremely efficient and reliable for use in high efficiency switch mode power supply and a wide variety of other applications.

Absolute Maximum Ratings ($T_C=25^{\circ}C$ unless otherwise specified)

Parameter	Symbol	Rating	Unit
Drain-Source Voltage	V_{DS}	-60	V
Gate-Source Voltage	V_{GS}	±20	V
Drain Current – Continuous ($T_C=25^{\circ}C$)	I_D	-7	A
Drain Current – Continuous ($T_C=100^{\circ}C$)		-4.4	A
Drain Current – Pulsed ¹	I_{DM}	-28	A
Single Pulse Avalanche Energy ²	E_{AS}	32	mJ
Single Pulse Avalanche Current ²	I_{AS}	-8	A
Power Dissipation ($T_C=25^{\circ}C$)	P_D	15.6	W
Power Dissipation – Derate above 25°C		0.125	W/°C
Storage Temperature Range	T_{STG}	-50 to +150	°C
Operating Junction Temperature Range	T_J	-50 to +150	°C

Thermal Characteristics

Parameter	Symbol	Typ.	Max.	Unit
Thermal Resistance Junction to Ambient	$R_{\theta JA}$	---	62	°C/W
Thermal Resistance Junction to Case	$R_{\theta JC}$	---	8	°C/W

Electrical Characteristics ($T_J=25^\circ\text{C}$ unless otherwise specified)

Parameter	Symbol	Conditions	Min.	Typ.	Max.	Unit
Off Characteristics						
Drain-Source Breakdown Voltage	BV_{DSS}	$V_{GS}=0V, I_D=-250\mu A$	-60	---	---	V
BV_{DSS} Temperature Coefficient	$\Delta BV_{DSS}/\Delta T_J$	Reference to 25°C , $I_D=-1mA$	---	-0.05	---	$V/^\circ\text{C}$
Drain-Source Leakage Current	I_{DSS}	$V_{DS}=-60V, V_{GS}=0V, T_J=25^\circ\text{C}$	---	---	-1	μA
		$V_{DS}=-48V, V_{GS}=0V, T_J=125^\circ\text{C}$	---	---	-10	μA
Gate-Source Leakage Current	I_{GSS}	$V_{GS}=\pm 20V, V_{DS}=0V$	---	---	± 100	nA
On Characteristics						
Static Drain-Source On-Resistance	$R_{DS(ON)}$	$V_{GS}=-10V, I_D=-3A$	---	153	180	$m\Omega$
		$V_{GS}=-4.5V, I_D=-1.5A$	---	198	220	$m\Omega$
Gate Threshold Voltage	$V_{GS(th)}$	$V_{GS}=V_{DS}, I_D=-250\mu A$	-1.2	-1.6	-2.5	V
$V_{GS(th)}$ Temperature Coefficient	$\Delta V_{GS(th)}$		---	5	---	$mV/^\circ\text{C}$
Forward Transconductance	g_{fs}	$V_{DS}=-10V, I_D=-2A$	---	3	---	S
Dynamic and Switching Characteristics						
Total Gate Charge ^{3, 4}	Q_g	$V_{DS}=-30V, V_{GS}=-10V, I_D=-3A$	---	8.2	12	nC
Gate-Source Charge ^{3, 4}	Q_{gs}		---	1.8	3.6	
Gate-Drain Charge ^{3, 4}	Q_{gd}		---	1.5	3	
Turn-On Delay Time ^{3, 4}	$T_{d(on)}$	$V_{DD}=-30V, V_{GS}=-10V, R_G=6\Omega, I_D=-1A$	---	5.2	10	nS
Rise Time ^{3, 4}	T_r		---	19	36	
Turn-Off Delay Time ^{3, 4}	$T_{d(off)}$		---	35	67	
Fall Time ^{3, 4}	T_f		---	10.6	20	
Input Capacitance	C_{iss}	$V_{DS}=-30V, V_{GS}=0V, F=1MHz$	---	425	615	pF
Output Capacitance	C_{oss}		---	35	50	
Reverse Transfer Capacitance	C_{rss}		---	20	30	
Drain-Source Diode Characteristics and Maximum Ratings						
Continuous Source Current	I_S	$V_G=V_D=0V$, Force Current	---	---	-7	A
Pulsed Source Current	I_{SM}		---	---	-28	A
Diode Forward Voltage	V_{SD}	$V_{GS}=0V, I_S=-1A, T_J=25^\circ\text{C}$	---	---	-1	V

Note:

1. Repetitive Rating: Pulsed width limited by maximum junction temperature.
2. $V_{DD}=-25V, V_{GS}=-10V, L=1mH, I_{AS}=-8A, R_G=25\Omega$, Starting $T_J=25^\circ\text{C}$.
3. The data tested by pulsed, pulse width $\leq 300\mu s$, duty cycle $\leq 2\%$.
4. Essentially independent of operating temperature.

Typical Electrical and Thermal Characteristic Curves

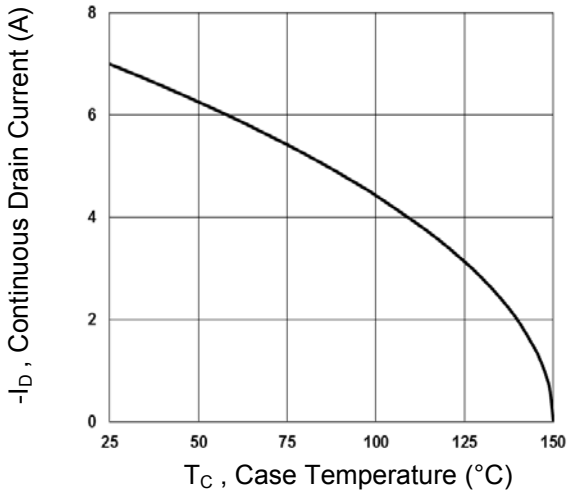

Fig.1 Continuous Drain Current vs. T_c

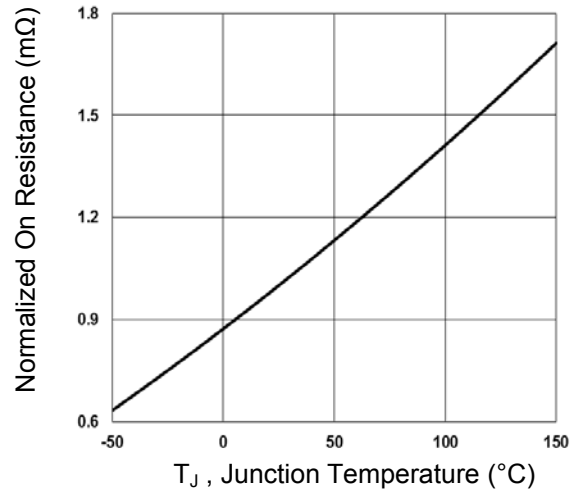

Fig.2 Normalized $R_{DS(ON)}$ vs. T_j

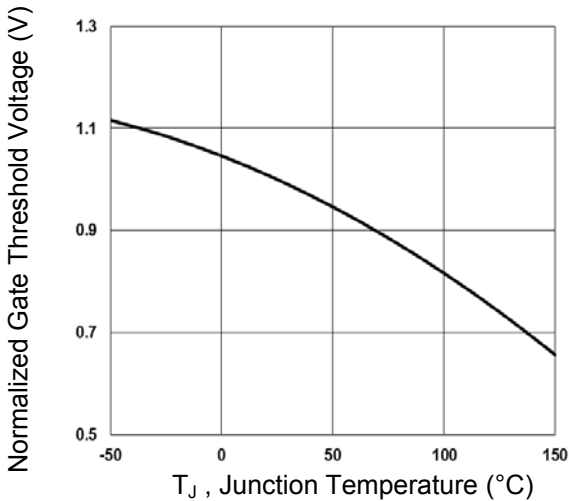

Fig.3 Normalized V_{th} vs. T_j

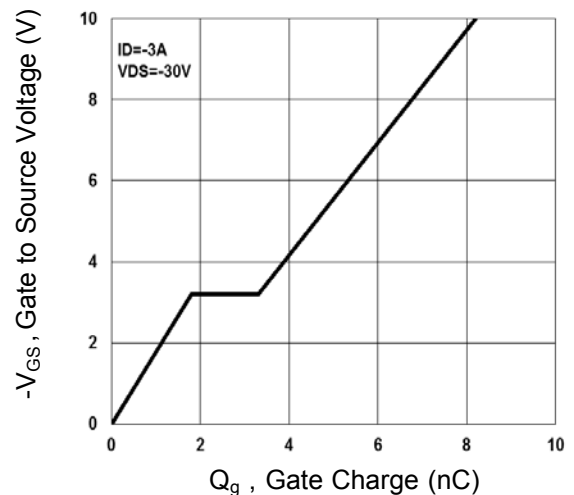

Fig.4 Gate Charge Waveform

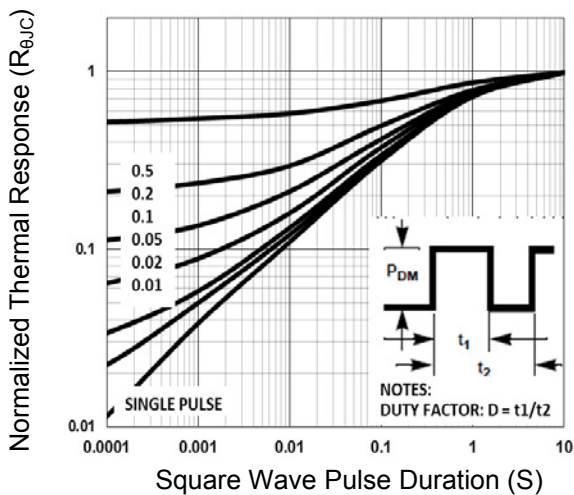

Fig.5 Normalized Transient Impedance

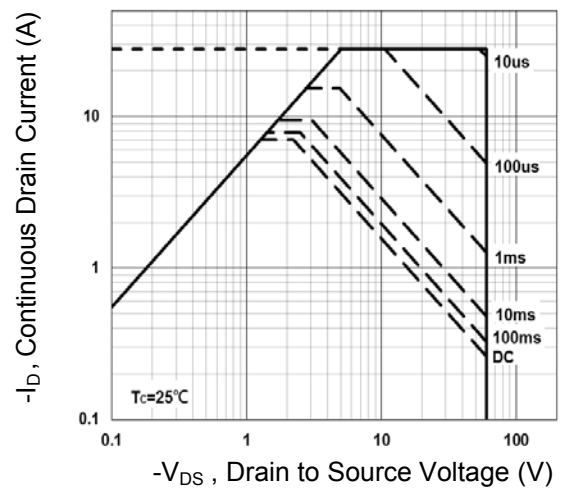

Fig.6 Maximum Safe Operation Area

Typical Electrical and Thermal Characteristic Curves

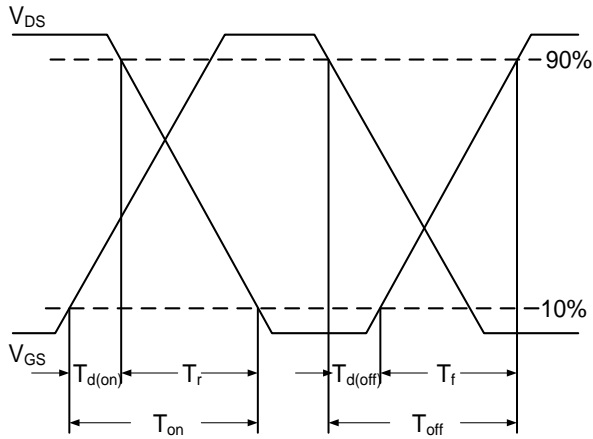

Fig.7 Switching Time Waveform

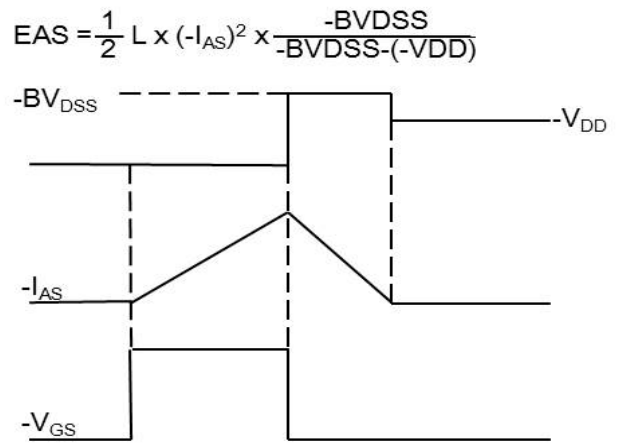
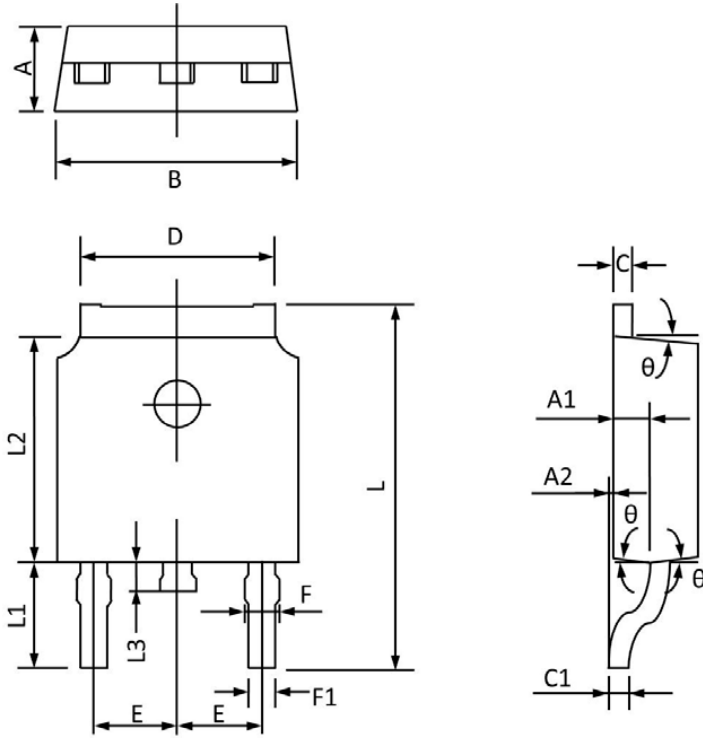

Fig.8 E_{AS} Waveform

Package Outline Dimensions

TO-252 (DPAK)



Symbol	Dimensions In Millimeters		Dimensions In Inches	
	Min	Max	Min	Max
A	2.20	2.40	0.087	0.094
A1	0.91	1.11	0.036	0.044
A2	0.00	0.15	0.000	0.006
B	6.50	6.70	0.256	0.264
C	0.46	0.580	0.018	0.230
C1	0.46	0.580	0.018	0.030
D	5.10	5.46	0.201	0.215
E	2.186	2.386	0.086	0.094
F	0.74	0.94	0.029	0.037
F1	0.660	0.860	0.026	0.034
L	9.80	10.40	0.386	0.409
L1	2.9REF		0.114REF	
L2	6.00	6.20	0.236	0.244
L3	0.60	1.00	0.024	0.039
θ	3°	9°	3°	9°