

GSTP1A thru GSTP7A

Surface Mount Glass Passivated Standard Rectifiers
 Reverse Voltage 50-1000V Forward Current 1A

Features

- Low forward voltage drop
- Low leakage current
- Glass passivated standard rectifiers
- Low profile - typical height of 0.65 mm
- Moisture sensitivity: level 1, per J-STD-020
- High temperature soldering guaranteed: 260°C/10 seconds
- Halogen-free according to IEC 61249-2-21 definition



Package: iSGP
(SOD-323HE)



RoHS
COMPLIANT

Maximum Ratings (T_A = 25°C unless otherwise noted)

Parameter	Symbol	GSTP 1A	GSTP 2A	GSTP 3A	GSTP 4A	GSTP 5A	GSTP 6A	GSTP 7A	Unit
Maximum Repetitive Peak Reverse Voltage	V _{RRM}	50	100	200	400	600	800	1000	V
Maximum RMS Voltage	V _{RMS}	35	70	140	280	420	560	700	V
Maximum DC Blocking Voltage	V _{DC}	50	100	200	400	600	800	1000	V
Maximum Average Forward Rectified Current at TL(See Fig.1)	I _{F(AV)}	1.0							A
Peak Forward Surge Current 8.3 ms Single Half Sine-wave Superimposed on Rated Load	I _{FSM}	20							A
Operating Junction and Storage Temperature Range	T _J , T _{STG}	- 55 to + 150							°C

Electrical Characteristics (T_A = 25°C unless otherwise noted)

Parameter	Test Conditions	Symbol	GSTP 1A	GSTP 2A	GSTP 3A	GSTP 4A	GSTP 5A	GSTP 6A	GSTP 7A	Unit
Maximum Instantaneous Forward Voltage	1 A	V _F	1.1							V
Maximum DC Reverse Current	T _A =25°C	I _R	5							µA
	T _A =125°C		50							
Typical Reverse Recovery Time	I _F =0.5A, I _R =1.0A, I _{rr} =0.25A	t _{rr}	1.8							µs

GSTP1A thru GSTP7A

Surface Mount Glass Passivated Standard Rectifiers
 Reverse Voltage 50-1000V Forward Current 1A

Ratings and Characteristics Curves ($T_A = 25^\circ\text{C}$ unless otherwise noted)

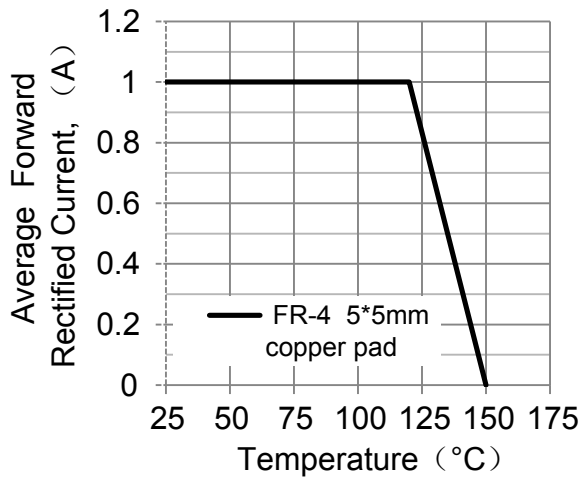

Figure 1. Forward Current Derating Curve

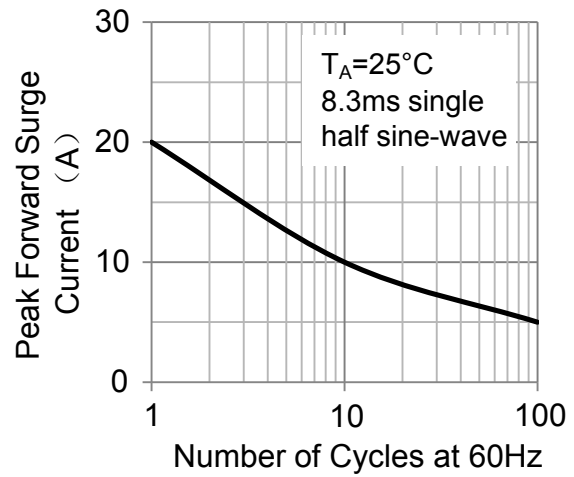

Figure 2. Maximum Non-Repetitive Peak Forward Surge Current

GSTP1A thru GSTP7A

Surface Mount Glass Passivated Standard Rectifiers
 Reverse Voltage 50-1000V Forward Current 1A

Package Outline Dimensions

iSGP (SOD-323HE)

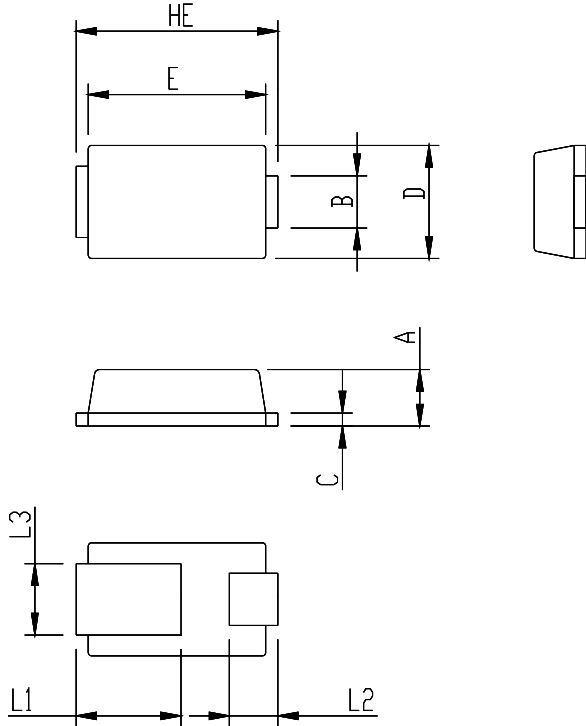

Package	Unit: mm	
iSGP	Min	Max
A	0.60	0.73
B	0.55	0.75
C	0.10	0.25
D	1.20	1.40
E	2.10	2.30
HE	2.30	2.70
L1	1.10	1.50
L2	0.40	0.75
L3	0.75	1.00

Soldering Footprint

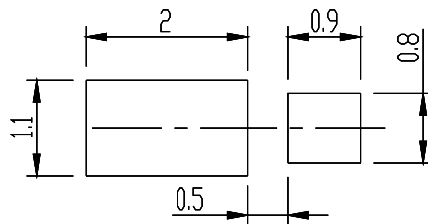

Packing Information

Packing quantities

10000 pcs/Reel, 16 Reels/Box, 8mm Tape, 13" Reel

Tape & Reel Specification

