

GS313C thru GS320C

Surface Mount General Purpose Rectifiers
 Reverse Voltage 1300V to 2000V Forward Current 3A

Features

- Plastic package has Underwriters Laboratory Flammability Classification 94V-0
- Construction utilizes void-free molded plastic technique
- For surface mounted applications
- Built-in strain relief, ideal for automated placement
- High temperature soldering guaranteed: 260°C/10 seconds at terminals
- Component in accordance to RoHS 2015/863/EU



DO-214AB (SMC)

Absolute Maximum Ratings and Electrical Characteristics

(Ratings at 25°C ambient temperature unless otherwise specified, Single phase ,half wave 60Hz, resistive or inductive load. For capacitive load, derated by 20%.)

Parameter	Symbol	GS313C	GS316C	GS318C	GS320C	Unit
Maximum Repetitive Peak Reverse Voltage	V_{RRM}	1300	1600	1800	2000	V
Maximum RMS Voltage	V_{RMS}	910	1120	1260	1400	V
Maximum DC Blocking Voltage	V_{DC}	1300	1600	1800	2000	V
Maximum Average Forward Rectified Current	$I_{(AV)}$	3.0				A
Peak Forward Surge Current (8.3ms Half Sine-wave Superimposed on Rated Load (JEDEC method))	I_{FSM}	100				A
Maximum Instantaneous Forward Voltage at 3.0A	V_F	1.15				V
Maximum Reverse Current at Rated DC Blocking Voltage	$T_A=25^{\circ}C$	I_R	5			uA
	$T_A=125^{\circ}C$		100			
Typical Thermal Resistance	$R_{\theta JA}$	40				°C/W
	$R_{\theta JL}$	15				
Junction Temperature	T_J	-55 to +150				°C
Storage Temperature	T_{STG}	-55 to +150				°C

Ratings and Characteristic Curves

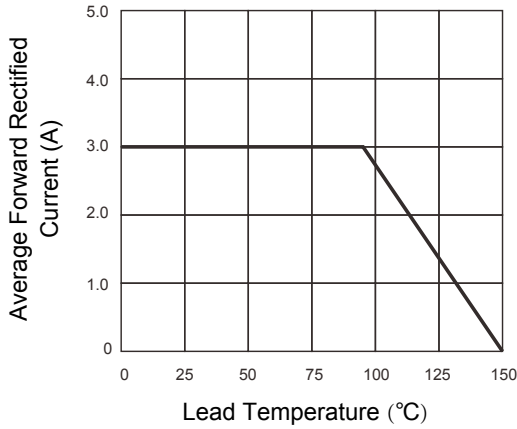

Figure 1. Forward Current Derating Curve

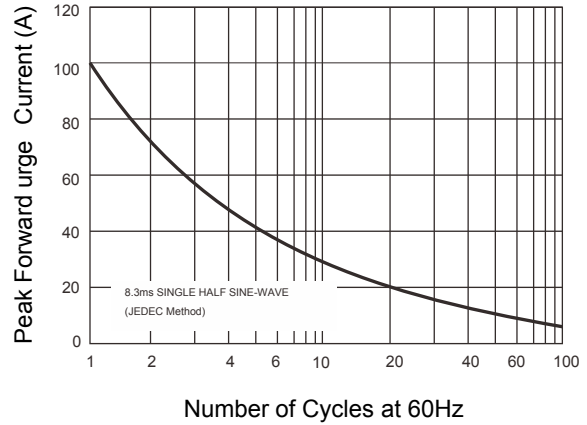

Figure 2. Maximum Non-Repetitive Peak Forward Surge Current

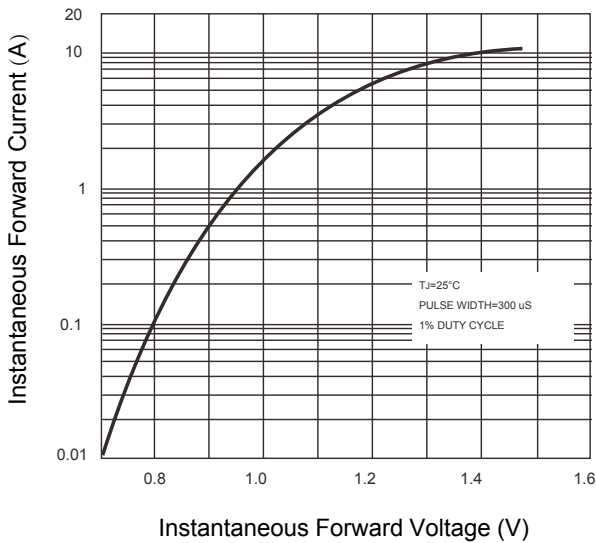

Figure 3. Typical Instantaneous Forward Characteristics

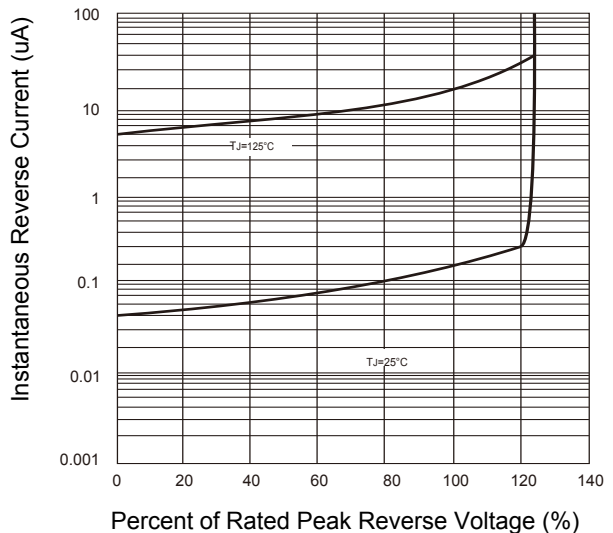
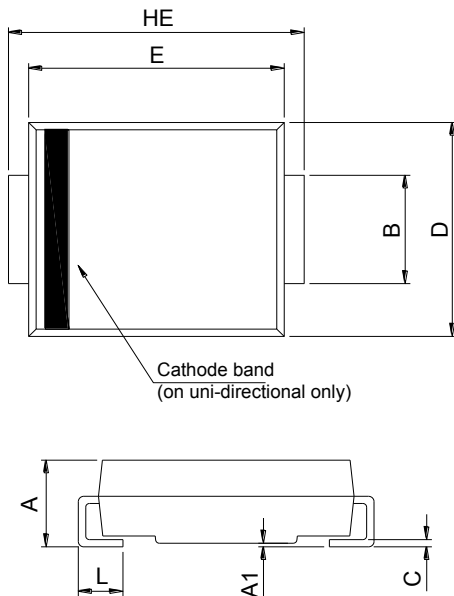

Figure 4. Typical Reverse Leakage Characteristics

GS313C thru GS320C

Surface Mount General Purpose Rectifiers
 Reverse Voltage 1300V to 2000V Forward Current 3A

Package Outline Dimensions DO-214AB (SMC)



SMC (DO-214AB)				
DIM	Millimeters		Inches	
	Min.	Max.	Min.	Max.
A	2.00	2.62	0.079	0.103
A1	0.00	0.20	0.000	0.008
B	2.75	3.25	0.108	0.128
C	0.15	0.31	0.006	0.012
D	5.58	6.22	0.220	0.245
E	6.60	7.15	0.260	0.281
HE	7.75	8.15	0.305	0.321
L	0.76	1.60	0.030	0.063

Recommended Pad Layout

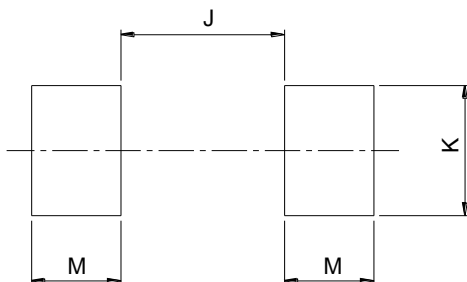

SMC Recommended Pad Layout (Reference ONLY)				
DIM	Millimeters		Inches	
	Min.	Max.	Min.	Max.
J	-	4.60	-	0.181
K	3.20	-	0.126	-
M	2.00	-	0.079	-

Order information

Device	Package	Marking	Quantity	HSF Status
GS313C	SMC	S313C	3,000pcs / Reel	RoHS Compliant
GS316C	SMC	S316C	3,000pcs / Reel	RoHS Compliant
GS318C	SMC	S318C	3,000pcs / Reel	RoHS Compliant
GS320C	SMC	S320C	3,000pcs / Reel	RoHS Compliant

For more information, please contact us at: inquiry@goodarksemi.com