

GSGBJ1501 thru GSGBJ1510

Bridge Rectifiers

Reverse Voltage 100V to 1000V Forward Current 15.0A

Features

- Plastic package has Underwriters Laboratory Flammability Classification 94V-0
- Glass passivated chip junction
- High current capability
- Low forward voltage drop
- High temperature soldering guaranteed: 260°C/10 seconds at terminals
- Component in accordance to RoHS 2015/863/EU

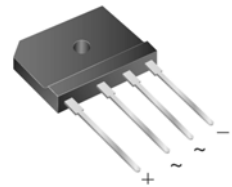

Package: GBJ

Mechanical Data

- Case: GBJ molded plastic body
- Terminals: Plated leads solderable per MIL-STD-750, method 2026
- Mounting position: Any

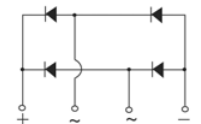

Schematic Diagram

Applications

Used in AC/DC bridge full wave rectification for SMPS, lighting ballaster, adapter, charger, home appliances, office equipment and telecommunication applications.

Maximum Ratings and Electrical Characteristics

(Rating at 25°C ambient temperature unless otherwise specified. Single phase, half wave, 60HZ, resistive or inductive load.

For capacitive load, derate current by 20%.)

Parameters	Symbols	GSGBJ 1501	GSGBJ 1502	GSGBJ 1504	GSGBJ 1506	GSGBJ 1508	GSGBJ 1510	Units
Maximum Recurrent Peak Reverse Voltage	V_{RRM}	100	200	400	600	800	1000	V
Maximum RMS Voltage	V_{RMS}	70	140	280	420	560	700	V
Maximum DC Blocking Voltage	V_{DC}	100	200	400	600	800	1000	V
Maximum Average Forward Rectified Current	$I_{F(AV)}$	15						A
Peak Forward Surge Current 8.3ms Single Half Sine-Wave Superimposed on Rated Load (JEDEC Method)	I_{FSM}	220						A
Rating for Fusing (t=8.3ms)	I^2t	200						A ² s
Maximum Instantaneous Forward Voltage at 7.5A DC	V_F	1.0						V
Maximum DC Reverse Current at Rated DC Blocking Voltage	I_R	$T_J=25^{\circ}C$						μA
		$T_J=125^{\circ}C$						μA
Typical Thermal Resistance, Junction-Ambient ¹	$R_{\theta JA}$	18						°C/W
Typical Thermal Resistance, Junction-Case ¹	$R_{\theta JC}$	1.5						
Operating Junction and Storage Temperature Range	T_J, T_{STG}	-55 to +150						C

Notes:

1. Device mounted on 75mm x 45mm x 5.5mm aluminum plate heatsink.

Ratings and Characteristics Curves ($T_A=25^\circ\text{C}$ unless otherwise noted)

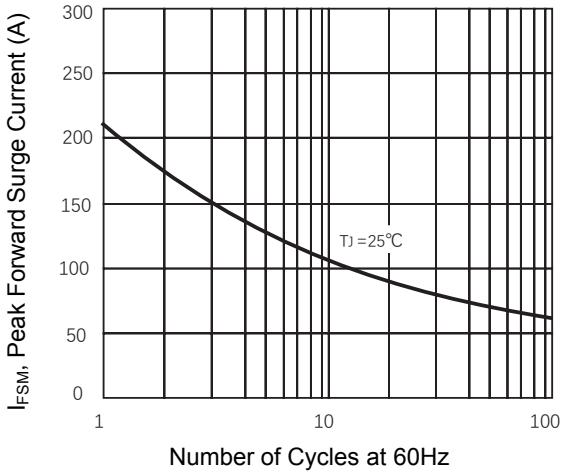

Figure 1. Maximum Forward Surge Current

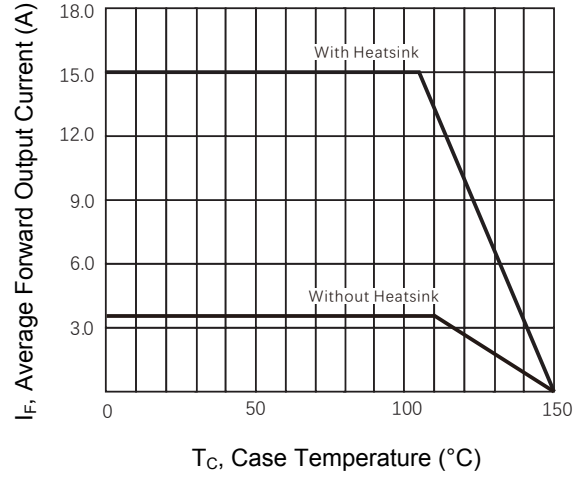

Figure 2. Forward Current Derating Curve

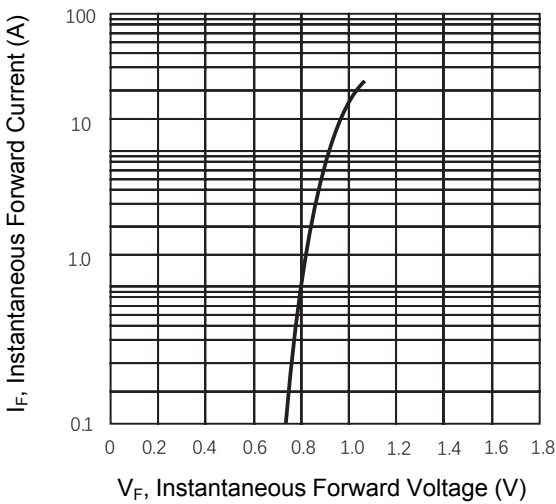

Figure 3. Typical Forward Characteristics

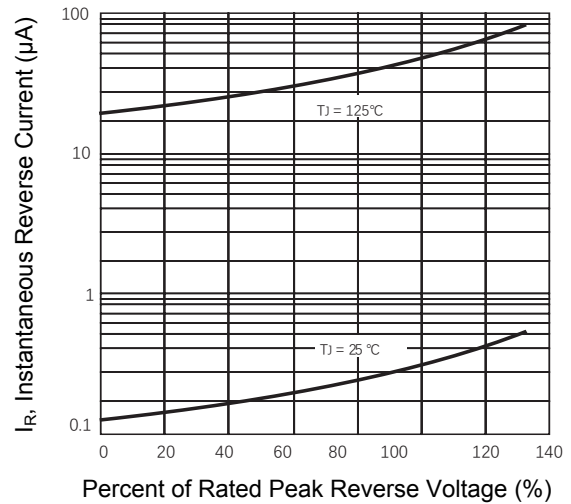

Figure 4. Typical Reverse Characteristics

GSGBJ1501 thru GSGBJ1510

Bridge Rectifiers

Reverse Voltage 100V to 1000V Forward Current 15.0A

Package Outline Dimensions (GBJ)

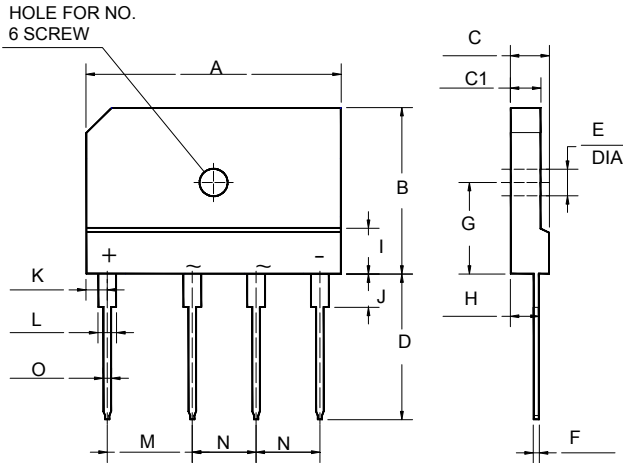

Symbol	Dimensions In Millimeters		Dimensions In Inches	
	Min.	Max.	Min.	Max.
A	29.70	30.30	1.169	1.193
B	19.70	20.30	0.776	0.800
C	4.40	4.80	0.173	0.189
C1	3.40	3.80	0.134	0.150
D	17.00	18.00	0.669	0.708
E	3.10	3.40	0.122	0.134
F	0.60	0.80	0.023	0.031
G	10.80	11.20	0.425	0.441
H	3.40	3.90	0.134	0.153
I	4.80	5.80	0.189	0.228
J	3.80	4.20	0.150	0.165
K	2.30	2.70	0.096	0.106
L	2.00	2.40	0.078	0.094
M	9.80	10.20	0.386	0.402
N	7.30	7.70	0.287	0.303
O	0.90	1.10	0.035	0.043