

GBJ25005A thru GBJ2510A

Bridge Rectifiers

Voltage Range 50V to 1000V Forward Current 25A

Features

- Glass passivated chip junction
- Thin single in-line package
- High surge current capability
- Solder dip 275 °C max. 7s, per JESD 22-B106

Typical Applications

General purpose use in AC/DC bridge full wave rectification for switching power supply, home appliances, office equipment, industrial automation applications.

Mechanical Data

- Package: GBJ (5S)
- Molding compound meets UL 94 V-0 flammability rating, RoHS compliant
- Terminals: Tin plated leads, solderable per J-STD-002 and JESD22-B102
- Polarity: As marked on body

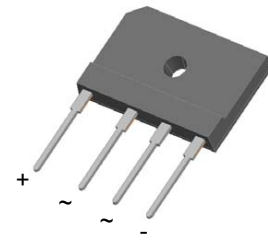

GBJ (5S)

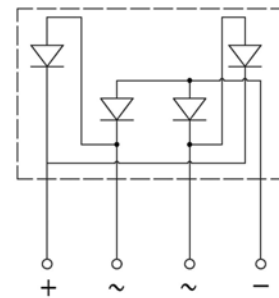

Schematic Diagram

Absolute Maximum Ratings (T_A=25°C Unless otherwise specified)

Parameter	Symbol	GBJ 25005A	GBJ 2501A	GBJ 2502A	GBJ 2504A	GBJ 2506A	GBJ 2508A	GBJ 2510A	Unit
Maximum Repetitive Peak Reverse Voltage	V _{RRM}	50	100	200	400	600	800	1000	V
Maximum RMS Voltage	V _{RMS}	35	70	140	280	420	560	700	V
Maximum DC Blocking Voltage	V _{DC}	50	100	200	400	600	800	1000	V
Average Rectified Output Current @ 60Hz Sine Wave, R-load ¹	with Heatsink T _c =100°C	25.0							A
	without Heatsink T _A =25°C	4.0							
Forward Surge Current (Non-Repetitive) @ 60Hz Half Sine Wave, 1 Cycle, T _J =25°C	I _{FSM}	350							A
Forward Surge Current (Non-Repetitive) @ 1ms Square Wave, 1 Cycle, T _J =25°C		700							
Current Squared Time @ 1ms ≤ t ≤ 8.3ms, T _J =25°C, Rating per Diode	I ² t	508							A ² S
Thermal Resistance, Between Junction and Ambient, without Heatsink ¹	R _{θJA}	18							°C/W
Thermal Resistance, Between Junction and Case, with Heatsink ¹	R _{θJC}	0.8							
Junction Temperature	T _J	-55 to +150							°C
Storage Temperature	T _{STG}	-55 to +150							°C
Dielectric Strength @ Terminals to Case, AC 1 Minute	V _{dis}	2.5							KV
Mounting Torque @ Recommend Torque: 5kg·cm	Tor	8.0							kg·cm

Note: 1. Device mounted on 75mm x 45mm x 5.5mm Aluminum Plate Heatsink.

Electrical Characteristics ($T_A=25^\circ\text{C}$ Unless otherwise specified)

Parameter	Symbol	Test Conditions	GBJ 25005A	GBJ 2501A	GBJ 2502A	GBJ 2504A	GBJ 2506A	GBJ 2508A	GBJ 2510A	Unit
Maximum Instantaneous Forward Voltage Drop Per Diode	V_F	$I_{FM}=12.5\text{A}$	1.0						V	
Maximum DC Reverse Current at Rated DC Blocking Voltage Per Diode	I_R	$T_J=25^\circ\text{C}$	5						μA	
		$T_J=125^\circ\text{C}$	100							
Typical Junction Capacitance	C_J	Measured at 1MHz and Applied Reverse Voltage of 4.0 V.D.C	116						pF	

Ratings and Characteristics Curves ($T_A=25^\circ\text{C}$ unless otherwise noted)

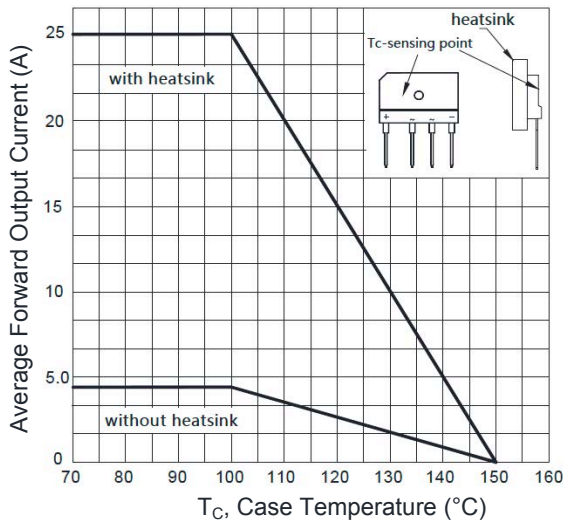

Figure 1. I_o - T_c Curve

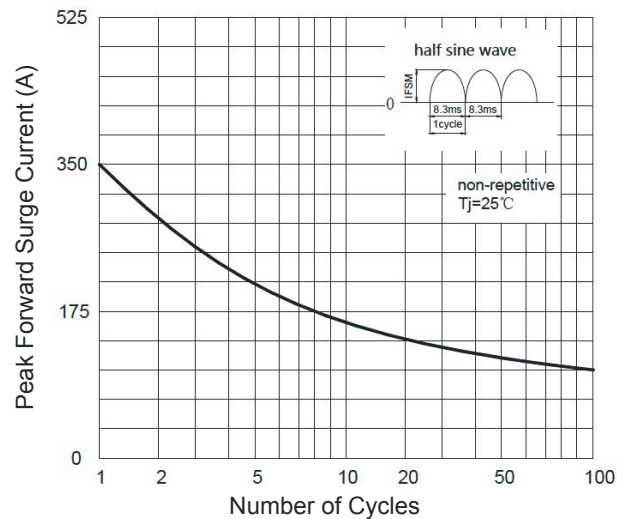

Figure 2. Surge Forward Current Capability

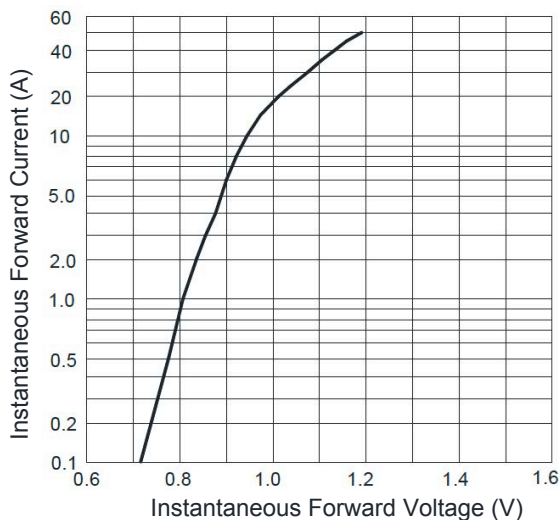

Figure 3. Typical Forward Voltage

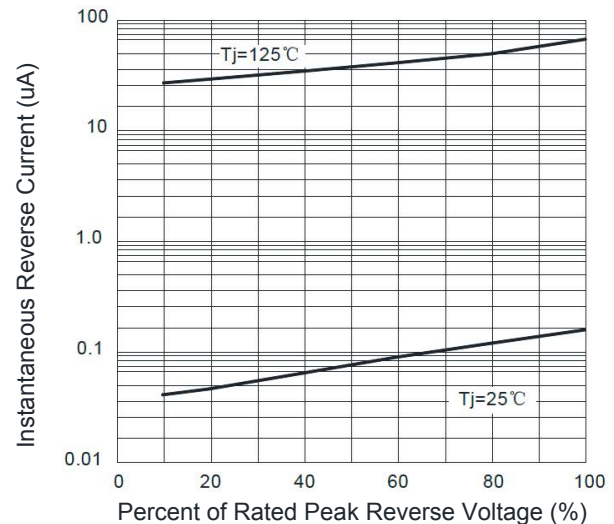

Figure 4. Typical Reverse Characteristics

GBJ25005A thru GBJ2510A

Bridge Rectifiers

Voltage Range 50V to 1000V Forward Current 25A

Package Outline Dimensions GBJ(5S)

HOLE FOR NO.
6 SCREW

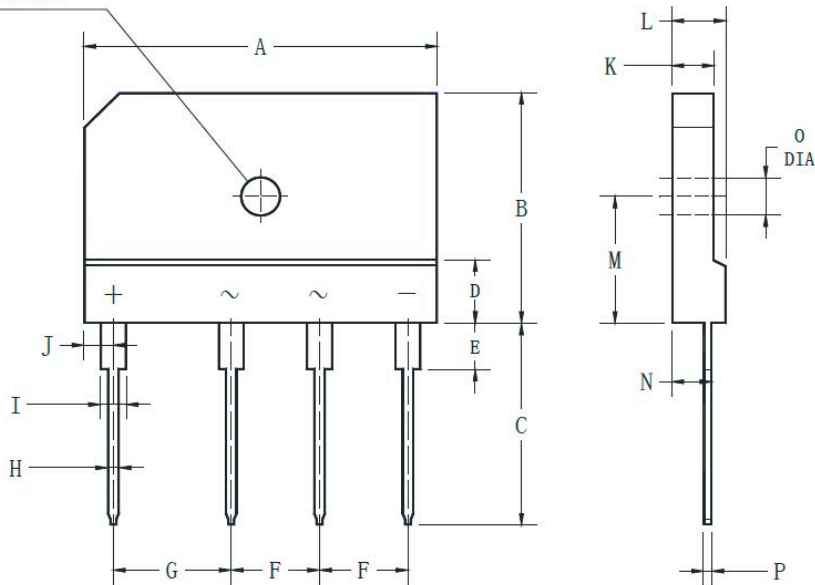

Symbol	Dimensions In Millimeters		Dimensions In Inches	
	Min	Max	Min	Max
A	29.700	30.300	1.169	1.193
B	19.700	20.300	0.776	0.799
C	17.000	18.000	0.669	0.709
D	4.800	5.800	0.189	0.228
E	3.800	4.200	0.150	0.165
F	7.300	7.700	0.287	0.303
G	9.800	10.200	0.386	0.402
H	0.900	1.100	0.035	0.043
I	2.000	2.400	0.079	0.094
J	2.300	2.700	0.091	0.106
K	3.400	3.800	0.134	0.150
L	4.400	4.800	0.173	0.189
M	10.800	11.200	0.425	0.441
N	3.100	3.700	0.122	0.146
O	3.100	3.400	0.122	0.134
P	0.600	0.800	0.024	0.031

GBJ25005A thru GBJ2510A

Bridge Rectifiers

Voltage Range 50V to 1000V Forward Current 25A

Order Information

Device	Package	Marking	Carrier	Quantity
GBJ25005A	GBJ(5S)	GBJ25005A	Tube	15 pcs / Tube
GBJ2501A	GBJ(5S)	GBJ2501A	Tube	15 pcs / Tube
GBJ2502A	GBJ(5S)	GBJ2502A	Tube	15 pcs / Tube
GBJ2504A	GBJ(5S)	GBJ2504A	Tube	15 pcs / Tube
GBJ2506A	GBJ(5S)	GBJ2506A	Tube	15 pcs / Tube
GBJ2508A	GBJ(5S)	GBJ2508A	Tube	15 pcs / Tube
GBJ2510A	GBJ(5S)	GBJ2510A	Tube	15 pcs / Tube