



BR10 Series

Glass Passivated Single-Phase Bridge Rectifiers
Voltage Range 50 to 1000 Volts Forward Current 10.0 Amperes

Features

- ◆ Surge overload rating - 200 Amperes peak
- ◆ Low forward voltage drop
- ◆ Small size, simple installation
- ◆ Sliver plated copper leads
- ◆ Mounting Position: Any

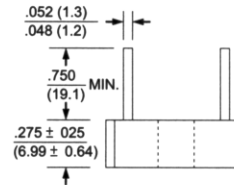
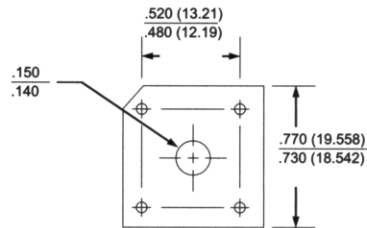

Polarity shown on side of case;
positive lead by beveled corner.

Maximum Ratings and Electrical Characteristics

Dimensions in inches and (millimeter)

Rating at 25°C ambient temperature unless otherwise specified.

Single phase, half wave, 60 Hz, resistive or inductive load.

For capacitive load, derate current by 20%

Parameter	Symbols	BR1005	BR101	BR102	BR104	BR106	BR108	BR1010	Units
Maximum recurrent peak reverse voltage	V_{RRM}	50	100	200	400	600	800	1000	Volts
Maximum RMS voltage	V_{RMS}	35	70	140	280	420	560	700	Volts
Maximum DC blocking voltage	V_{DC}	50	100	200	400	600	800	1000	Volts
Maximum average forward rectified output current at $T_C=50^\circ\text{C}$ $T_C=100^\circ\text{C}$ (Note 1) $T_A=50^\circ\text{C}$ (Note 2)	$I_{F(AV)}$					10.0 6.0 6.0			Amps
Peak forward surge current, 8.3ms single half sine-wave superimposed on rated load (JEDEC Method)	I_{FSM}					200.0			Amps
Max. instantaneous forward voltage drop per element at 5.0A	V_F					1.1			Volts
Maximum DC reverse current at rated DC blocking voltage per element $T_A=25^\circ\text{C}$ $T_A=100^\circ\text{C}$	I_R					10.0 1.0			μA mA
Operating temperature range	T_J					-55 to +125			$^\circ\text{C}$
Storage temperature range	T_{STG}					-55 to +150			$^\circ\text{C}$

- Notes:**
1. Unit mounted on metal chassis
 2. Unit mounted on P.C. board

RATINGS AND CHARACTERISTIC CURVES

($T_A = 25^\circ\text{C}$ unless otherwise noted)

FIG. 1 - MAXIMUM FORWARD SURGE CURRENT

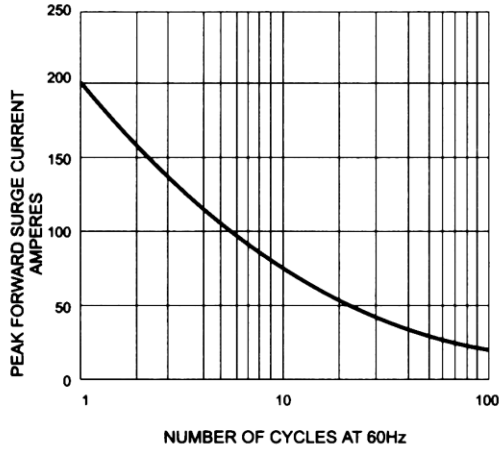

FIG. 2 - DERATING CURVE
OUTPUT RECTIFIED CURRENT

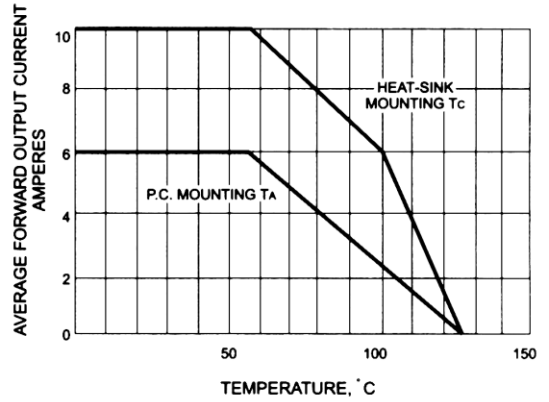

FIG. 3 - TYPICAL FORWARD CHARACTERISTICS

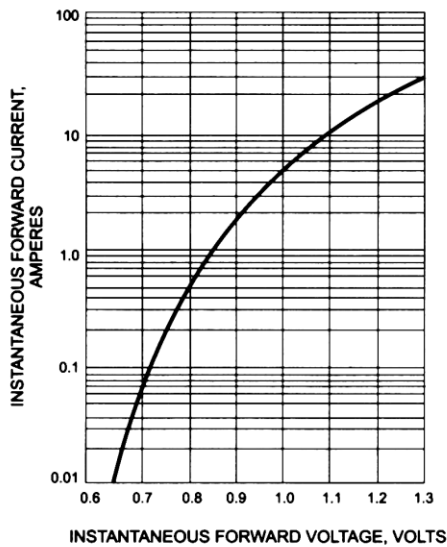

FIG. 4 - TYPICAL REVERSE CHARACTERISTICS

