

GARGOA thru GARGOM

Fast Recovery Surface Mount Rectifiers
 Reverse Voltage 50 to 1000V Forward Current 1.5A

Features

- Glass passivated chip
- Fast switching for high efficiency
- Low reverse leakage current
- Low forward voltage drop
- High current capability
- AEC-Q101 qualified



DO-214AA(SMB)

Absolute Maximum Ratings (T_A=25°C unless otherwise specified)

Parameter	Symbol	GARG OA	GARG OB	GARG OD	GARG OG	GARG OJ	GARG OK	GARG OM	Unit
Maximum Repetitive Peak Reverse Voltage	V _{RRM}	50	100	200	400	600	800	1000	V
Maximum RMS Voltage	V _{RMS}	35	70	140	280	420	560	700	V
Maximum DC Blocking Voltage	V _{DC}	50	100	200	400	600	800	1000	V
Maximum Average Forward Rectified Current (T _L =90°C)	I _(AV)	1.5							A
Peak Forward Surge Current 8.3ms Single Half Sine-wave Superimposed on Rated Load	I _{FSM}	50							A
Typical Thermal Resistance, Junction to Lead	R _{θJL}	18							°C/W
Operating Junction Temperature Range	T _J	-55 To +150							°C
Storage Temperature Range	T _{STG}	-55 To +150							°C

Electrical Characteristics (T_A=25°C unless otherwise specified)

Parameter	Symbol	Conditions	GARG OA	GARG OB	GARG OD	GARG OG	GARG OJ	GARG OK	GARG OM	Unit
Maximum Instantaneous Forward Voltage	V _F	I _R =1.5A	1.3				1.3	1.3		V
Maximum DC Reverse Current at Rated DC Blocking Voltage	I _R	T _J =25°C	5				5	5		μA
		T _J =125°C	200				200	200		
Maximum Reverse Recovery Time ¹	t _{rr}	I _F =0.5A, I _R =1.0A, I _{rr} =0.25A	150				250	500		nS
Typical Junction Capacitance ²	C _J	4.0 V, 1 MHz	50							pF

Notes: 1. Reverse Recovery Test Conditions: I_F=0.5A, I_R=1.0A, I_{RR}=0.25A

2. Measured at 1.0MHz and applied reverse voltage of 4.0V D.C.

GARGOA thru GARGOM

Fast Recovery Surface Mount Rectifiers
 Reverse Voltage 50 to 1000V Forward Current 1.5A

Typical Electrical Characteristic Curves ($T_A=25^\circ\text{C}$ unless otherwise noted)

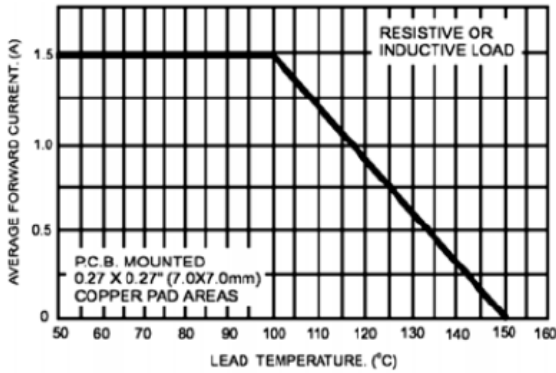

Figure 1. Maximum Forward Current Derating Curve

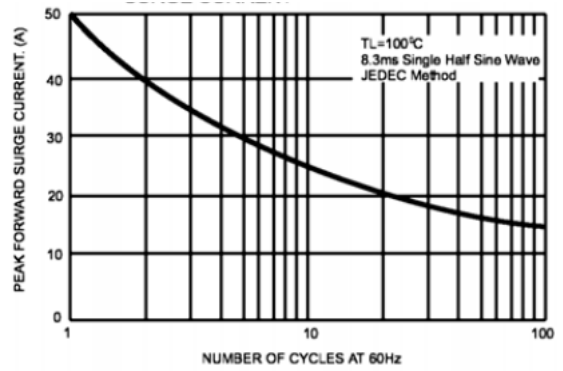

Figure 2. Maximum Non-Repetitive Peak Forward Surge Current

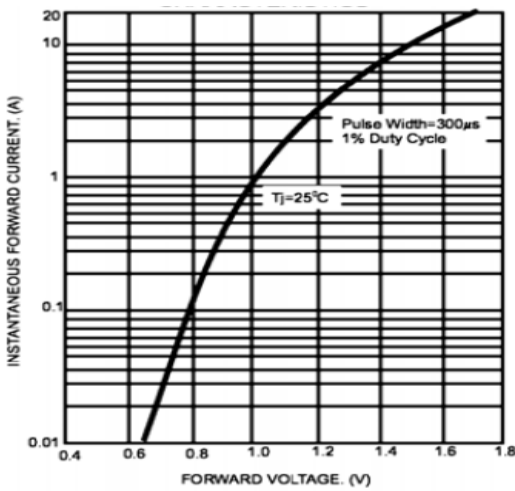

Figure 3. Typical Instantaneous Forward Characteristics

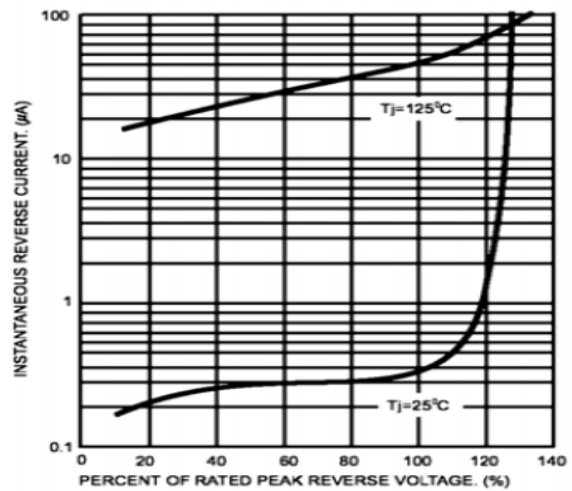

Figure 4. Typical Reverse Characteristics

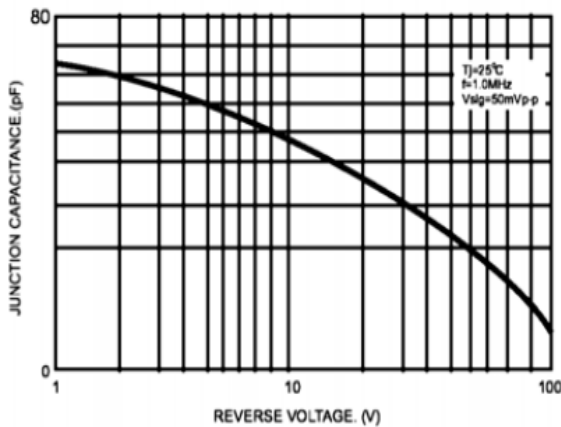
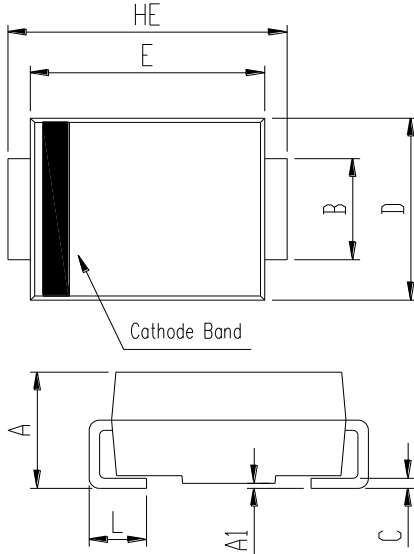

Figure 5. Typical Junction Capacitance

GARGOA thru GARGOM

Fast Recovery Surface Mount Rectifiers
 Reverse Voltage 50 to 1000V Forward Current 1.5A

Package Outline Dimensions DO214-AA(SMB)



DIM	SMB (DO-214AA)			
	Millimeters		Inches	
	Min.	Max.	Min.	Max.
A	1.99	2.61	0.078	0.103
A1	0.00	0.20	0.000	0.008
B	1.93	2.08	0.076	0.082
C	0.15	0.31	0.006	0.012
D	3.48	3.73	0.137	0.147
E	4.25	4.75	0.167	0.187
HE	5.26	5.46	0.207	0.215
L	0.90	1.41	0.035	0.056

Recommended Pad Layout

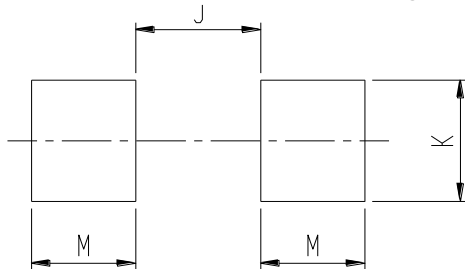

DIM	Recommended Pad Layout (Reference Only)			
	Millimeters		Inches	
	Min.	Max.	Min.	Max.
J	-	2.60	-	0.102
K	2.20	-	0.087	-
M	1.80	-	0.071	-