

Features

- 270W peak pulse power ($t_p=8/20\mu s$)
- SOD-523 package
- Fast response time, typically $< 1ns$
- Excellent clamping voltage
- Low leakage current
- IEC 61000-4-2 $\pm 30kV$ (Air) ESD protection
- IEC 61000-4-2 $\pm 30kV$ (Contact) ESD protection
- IEC 61000-4-5 15A (8/20us) Surge protection
- IEC 61000-4-4 40A (5/50ns) EFT protection
- RoHS compliant

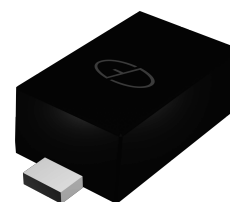

SOD-523

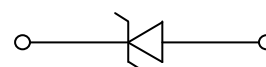

Schematic Diagram

Applications

- Cellular phones
- Portable devices
- Digital cameras
- Power supplies

Absolute Maximum Ratings

($T_A=25^\circ C$ unless otherwise specified)

Parameter	Symbol	Value	Unit
Peak Pulse Power ($T_P=8/20\mu S$)	P_{PP}	270	W
Peak Pulse Current ($T_P=8/20\mu S$)	I_{PP}	15	A
Operating Temperature	T_J	-55 to 150	$^\circ C$
Storage Temperature	T_{STG}	-55 to 150	$^\circ C$

Electrical Characteristics

($T_A=25^\circ C$ unless otherwise specified)

Parameter	Symbol	Condition	Min	Typ	Max	Unit
Reverse Stand-Off Voltage	V_{RWM}	-	-	-	5	V
Reverse Breakdown Voltage	V_{BR}	$I_T=1mA$	6.0	-	-	V
Reverse Leakage Current	I_R	$V_R=5V$	-	-	0.5	μA
Clamping Voltage	V_C	$I_{PP}=15A, T_P=8/20\mu S$	-	12	18	V
Junction Capacitance	C_J	$V_R=0V, f=1MHz$	-	80	-	pF

Typical Characteristic Curves

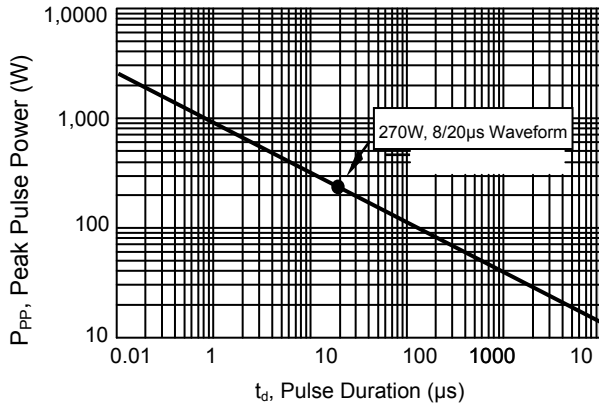

Figure 1. Peak Pulse Power vs. Pulse Time

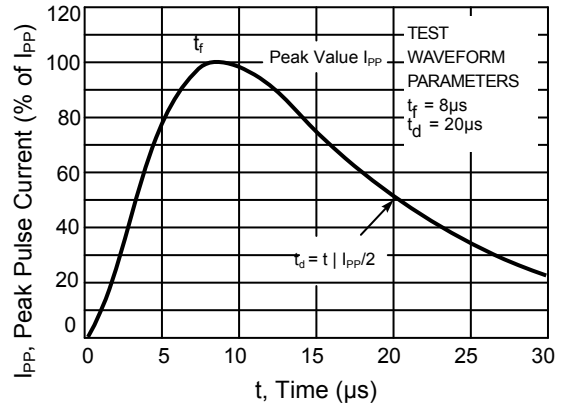

Figure 2. Pulse Wave Form (8/20 μ s)

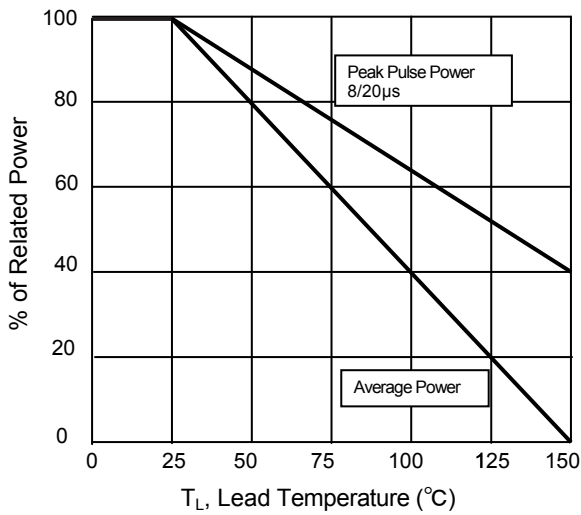

Figure 3. Power Derating Curve

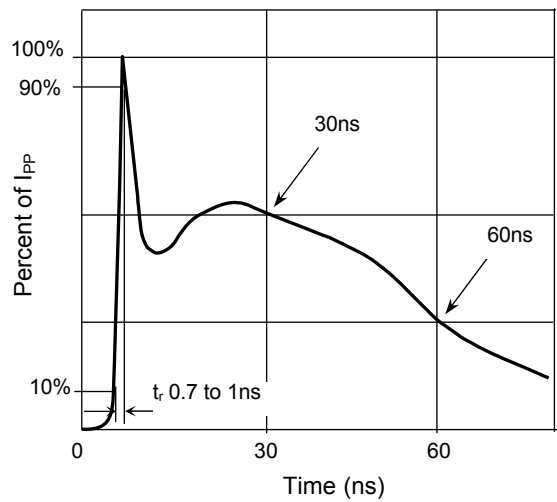
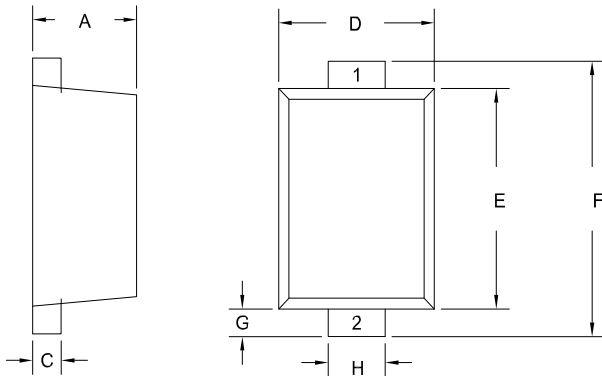

Figure 4. Pulse Waveform-ESD (IEC61000-4-2)

Package Outline Dimensions (SOD-523)



Symbol	Dimension in Millimeters	
	Min	Max
A	0.50	0.70
C	0.07	0.20
D	0.70	0.90
E	1.10	1.30
F	1.50	1.70
G	0.15	0.25
H	0.25	0.35

Order Information

MPN	Package	Marking	Carrier	Quantity	HSF Status
GSEV5U800	SOD-523	5H	Tape & Reel	3,000pcs / Reel	RoHS compliant