

**Features**

- Low current rectification
- Low forward voltage
- RoHS compliant
- UL-94 V-0 / Green EMC

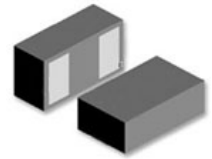

DFN0603

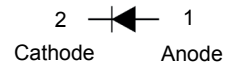

Schematic Diagram

Maximum Ratings ($T_A=25^\circ\text{C}$ unless otherwise specified)

Parameter	Symbol	Value	Units
Power Dissipation	P_D	100	mW
Reverse Voltage	V_R	30	V
Average Forward Current	$I_{F(AV)}$	100	mA
Non-Repetitive Peak Forward Current ¹	I_{FSM}	500	mA
Junction Temperature	T_J	125	$^\circ\text{C}$
Storage Temperature	T_{STG}	-55 to +125	$^\circ\text{C}$

Note:

1. 8.3ms single half sine-wave

Electrical Characteristics ($T_A=25^\circ\text{C}$ unless otherwise specified)

Parameter	Symbol	Conditions	Min	Typ	Max	Unit
Reverse Leakage Current	I_R	$V_R=10\text{V}$	-	-	10	uA
		$V_R=30\text{V}$	-	-	50	
Forward Voltage	V_F	$I_F=10\text{mA}$	-	-	0.38	V
		$I_F=100\text{mA}$	-	0.46	0.53	
Reverse Voltage	V_R	$I_R=50\text{uA}$	30	-	-	V

Typical Characteristic

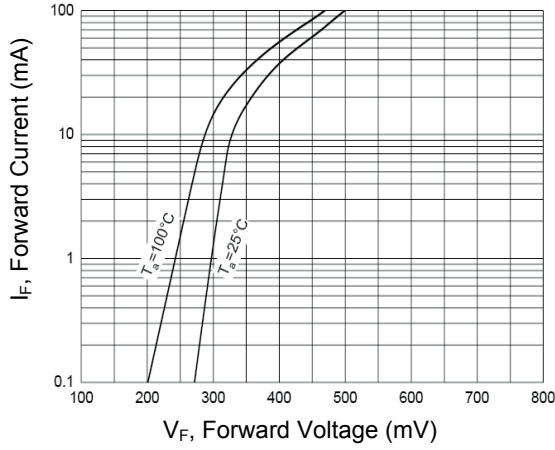

Figure 1. Forward Characteristics

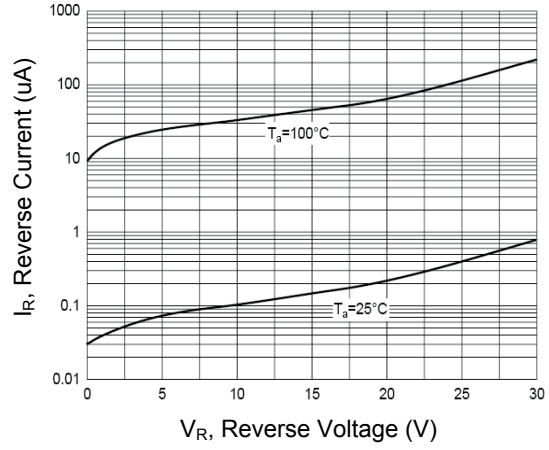

Figure 2. Reverse Characteristics

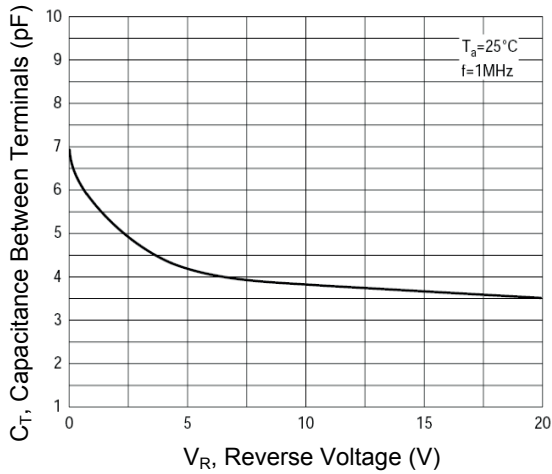

Figure 3. Capacitance Characteristics

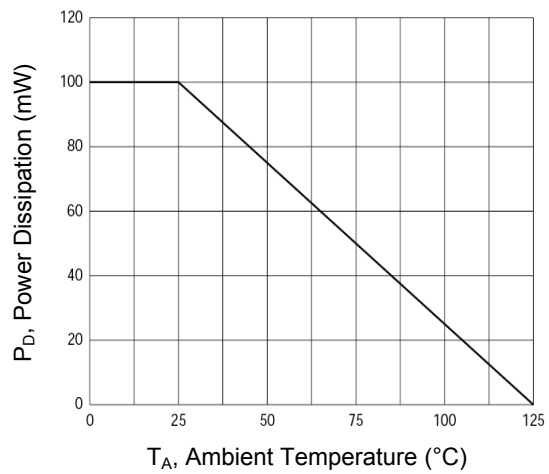
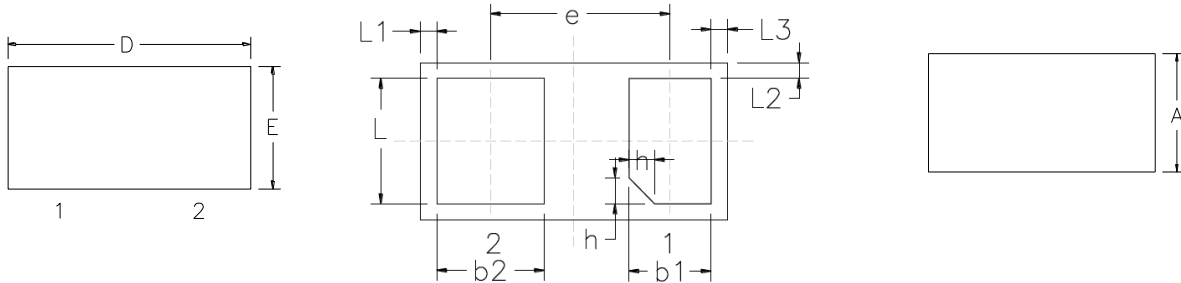

Figure 4. Power Derating Curve

Package Outline Dimensions (DFN0603)



Symbol	Dimensions In Millimeters		Dimensions In Inches	
	Min.	Max.	Min.	Max.
A	0.28	0.32	0.011	0.013
b1	0.13	0.23	0.005	0.009
b2	0.14	0.24	0.006	0.009
D	0.55	0.65	0.022	0.026
e	0.350 BSC		0.014 BSC	
L1	0.030 BSC		0.001 BSC	
L2	0.025 BSC		0.001 BSC	
L3	0.035 BSC		0.001 BSC	
E	0.25	0.35	0.010	0.014
L	0.20	0.30	0.008	0.012
h	0.00	0.10	0.000	0.004

Recommended Pad Layout

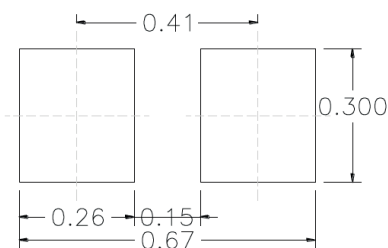

Note:

1. Controlling dimension: in millimeters
2. General tolerance: $\pm 0.05\text{mm}$

Order Information

Device	Package	Marking	Carrier	Quantity
GSRB521D3-30	DFN0603	F	Tape & Reel	15,000 pcs / 7" Reel